

S45033CF

2021-UP BMW M4 G82/M3 G80, 3.0L, AXLE-BACK ACTIVE, 3.0"
DUAL REAR, QUAD TIPS

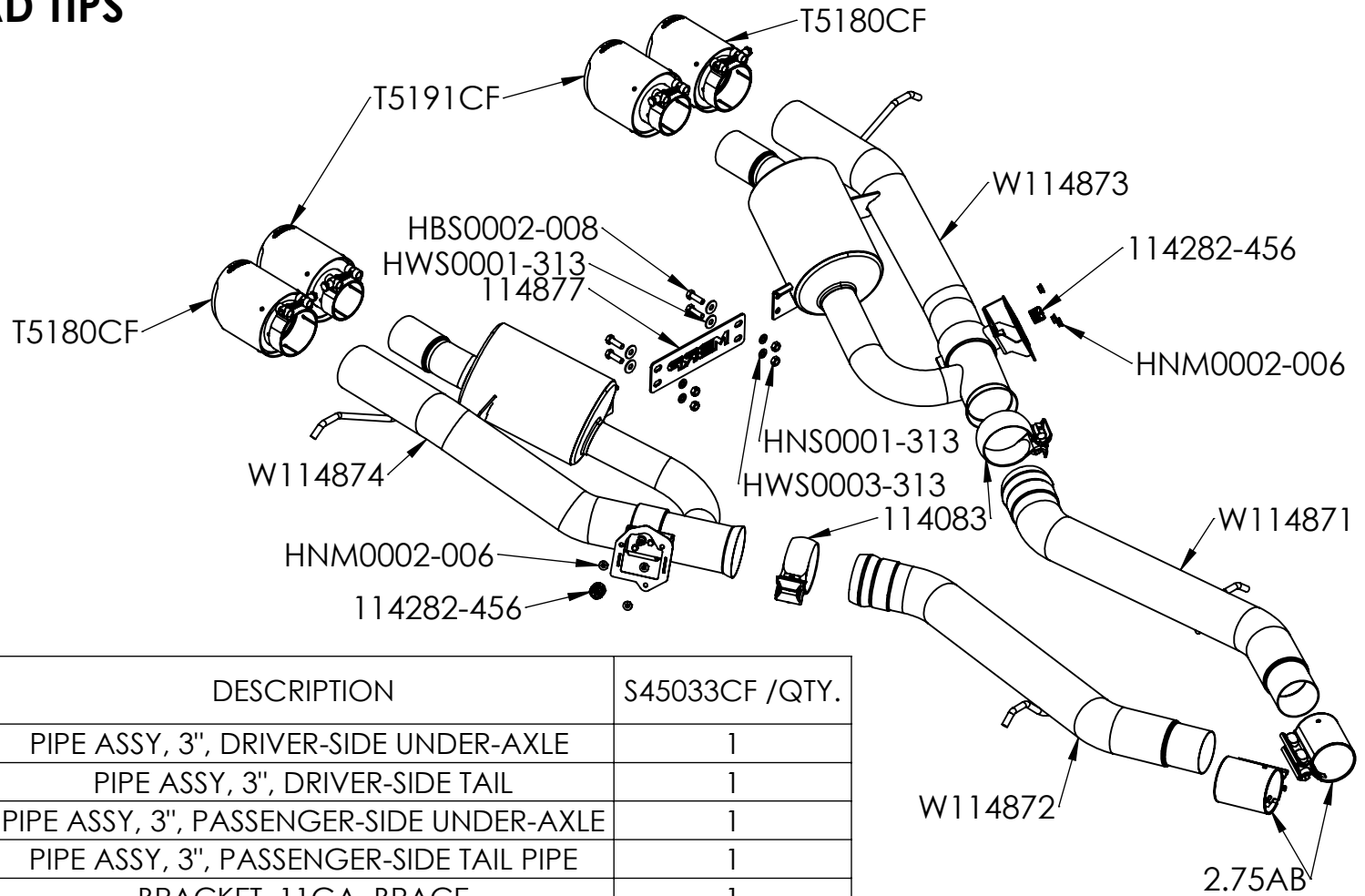

| ITEM NO. | PART NUMBER | DESCRIPTION | S45033CF /QTY. |
|----------|-------------|--|----------------|
| 1 | W114871 | PIPE ASSY, 3", DRIVER-SIDE UNDER-AXLE | 1 |
| 2 | W114873 | PIPE ASSY, 3", DRIVER-SIDE TAIL | 1 |
| 3 | W114872 | PIPE ASSY, 3", PASSENGER-SIDE UNDER-AXLE | 1 |
| 4 | W114874 | PIPE ASSY, 3", PASSENGER-SIDE TAIL PIPE | 1 |
| 5 | 114877 | BRACKET, 11GA, BRACE | 1 |
| 6 | 114083 | BAND CLAMP, SEC75 SWIVELSEAL | 2 |
| 7 | 2.75AB | CLAMP, 2.75, BUTT | 2 |
| 8 | 114282-456 | SPRING, DRIVE | 2 |
| 9 | HBS0002-008 | BOLT, HEX, 5/16-18 X 1.0", GR5, ZN | 4 |
| 10 | HNS0001-313 | NUT, HEX, 5/16" | 4 |
| 11 | HWS0001-313 | WASHER, FLAT, 5/16", (7/8"OD) ZN | 4 |
| 12 | HWS0003-313 | WASHER LOCKING 5/16 ZINC COATED | 4 |
| 13 | HNM0002-006 | NUT, HEX, FLANGE, M6X1.0 | 6 |
| 14 | T5180CF | TIP, 3" IN, 4.5" OD OUT, CF | 2 |
| 15 | T5191CF | TIP, 2.5" IN, 4.5" OD OUT, 6.5" L CF | 2 |

November 29, 2022
REV:A

