

# Installation instructions

For set # 11.10101  
06-14 Mazda MX-5 Miata  
Power Steering Gear Bushings



1131 VIA CALLEJON, SAN CLEMENTE, CA 92673

© 2014 Energy Suspension. All rights reserved.  
May not be reproduced, in any form, or by any means,  
without the written consent of Energy Suspension.

It is recommended that if you are unfamiliar with this type of work that you refer to a qualified service center specializing in this type of work. It is also recommended that if you choose to do this work yourself that a factory service manual be obtained for the proper procedures pertaining to removal, replacement and proper torque specifications for your vehicle. This instruction set is intended as a guideline for the safe installation of Energy Suspension's polyurethane bushings, once you have removed the factory components from your vehicle. Wheel alignment is almost always disturbed when suspension components are removed or replaced. It is recommended that you have the alignment checked on your vehicle at a qualified alignment shop. Energy Suspension recommends that you read over all the installation instructions and check all P/N's and quantities in the parts list before you start. Call customer service at 949-361-3935 if the parts in your kit do not match this parts list. Prior to installation, make sure that your vehicle is in excellent mechanical condition and that there are no suspension or steering related problems. This part has been designed to work only with a vehicle that is in good state of repair. No matter how carefully we design our parts, this is one area we have no control over and cannot be held responsible.

## STEERING GEAR AND LINKAGE REMOVAL/INSTALLATION

**ATTENTION:** We recommend acquiring a Mazda factory workshop manual for all warnings and procedures to safely remove and install the power steering gear.

**CAUTION:** Performing the following procedures without first removing the ABS wheel-speed sensor may possibly cause an open circuit in the harness if it is pulled by mistake. Before performing the following procedures, remove the ABS wheel-speed sensor (axle side) and fix it to an appropriate place where the sensor will not be pulled by mistake while servicing the vehicle.

**REMOVAL:** Properly lift and support the vehicle with jack stands. Remove both front wheels. Remove the ABS wheel-speed sensor. Remove the splash shield. Remove the front under cover. Remove the front stabilizer. Remove the intermediate shaft bolt (Place a matchmark on the steering intermediate shaft assembly and power steering gear splines for reassembly later **Fig.1**). Remove both cotter pins and nuts from the tie rod ends at steering knuckle. Disconnect both tie rod ends from steering knuckle. Remove radiator lower mount brackets. Disconnecting the power steering fluid lines will be necessary. Remove pressure pipe, return hose & return pipe. Remove the steering gear and linkage by pulling it from the right side. Use a press to remove old rubber bushings **Fig.2**. Install 10P10063 in top and bottom of both eyes then install 15.10.520.39 inner metal sleeve then install 10P10064 **Fig.3**. Slide the power steering gear back in place, leave bolts finger tight. Tighten the mounting bracket bolts to the specified torque in the order shown **Fig.4**. Install in the reverse order of removal. Connect the tie rod ends to the steering knuckles with the nut. Install a new cotter pin. Replace copper washers with new washers. Align matchmark on the steering intermediate shaft assembly and power steering gear splines. We recommended that you have the alignment checked on your vehicle at a qualified alignment shop.

### Parts list: 11.10101

- 4 - 10P10063 Bushing driver side
- 2 - 15.10.520.39 .875" x .500" x 1.480" Sleeve
- 1 - 10P10064 Bushing passenger side
- 1 - 17P17640 Instruction Sheet

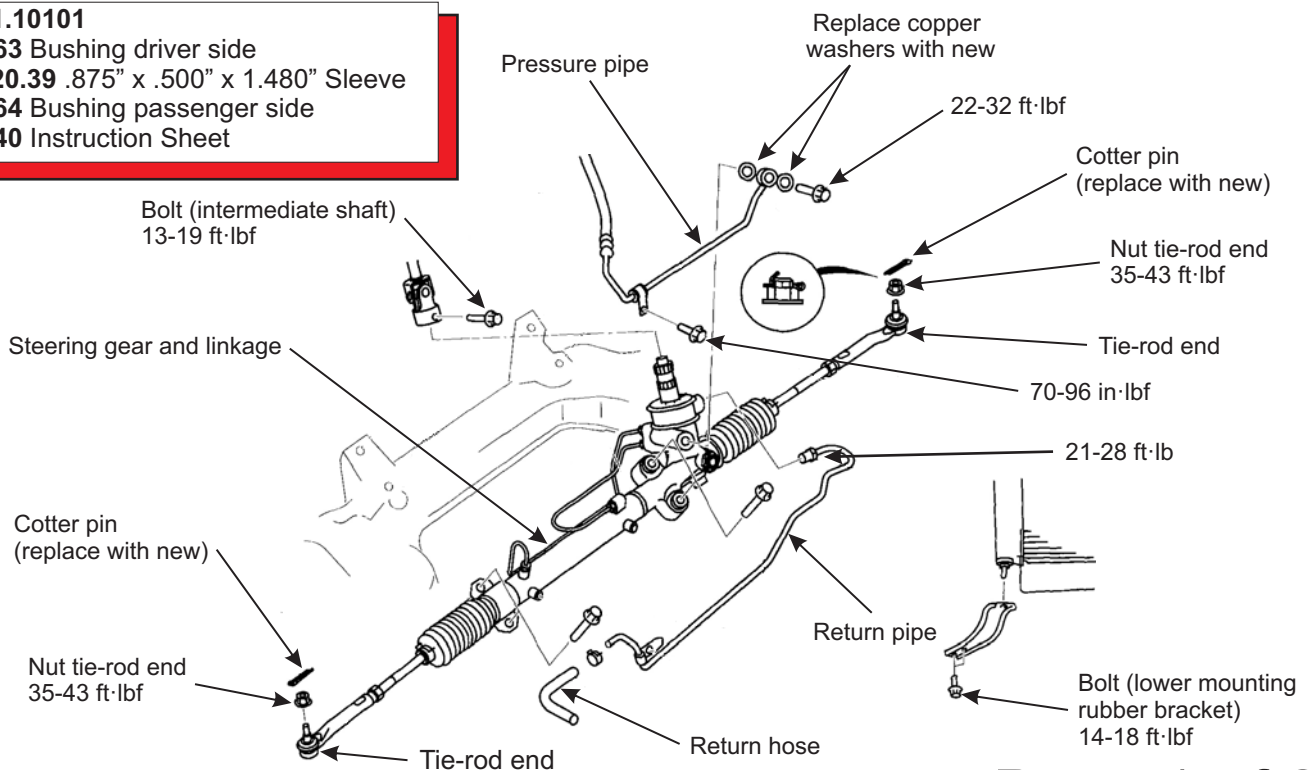

# Installation instructions

For set # 11.10101  
06-14 Mazda MX-5 Miata  
Power Steering Gear Bushings

© 2014 Energy Suspension. All rights reserved.  
May not be reproduced, in any form, or by any means,  
without the written consent of Energy Suspension.

It is recommended that if you are unfamiliar with this type of work that you refer to a qualified service center specializing in this type of work. It is also recommended that if you choose to do this work yourself that a factory service manual be obtained for the proper procedures pertaining to removal, replacement and proper torque specifications for your vehicle. This instruction set is intended as a guideline for the safe installation of Energy Suspension's polyurethane bushings, once you have removed the factory components from your vehicle. Wheel alignment is almost always disturbed when suspension components are removed or replaced. It is recommended that you have the alignment checked on your vehicle at a qualified alignment shop. Energy Suspension recommends that you read over all the installation instructions and check all P/N's and quantities in the parts list before you start. Call customer service at 949-361-3935 if the parts in your kit do not match this parts list. Prior to installation, make sure that your vehicle is in excellent mechanical condition and that there are no suspension or steering related problems. This part has been designed to work only with a vehicle that is in good state of repair. No matter how carefully we design our parts, this is one area we have no control over and cannot be held responsible.

Fig. 1

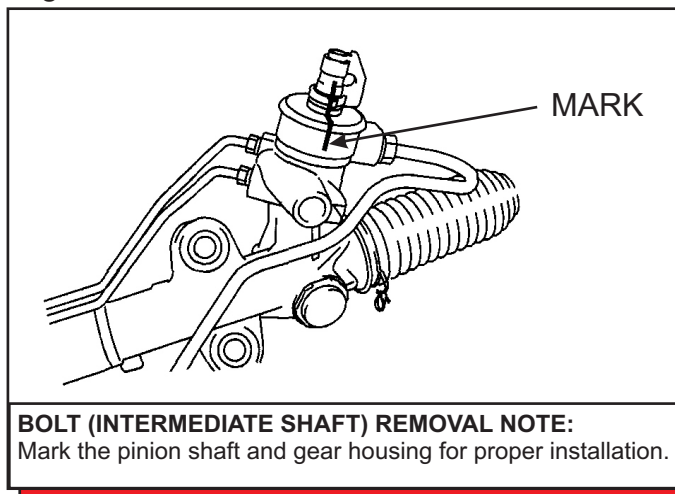

Fig. 2

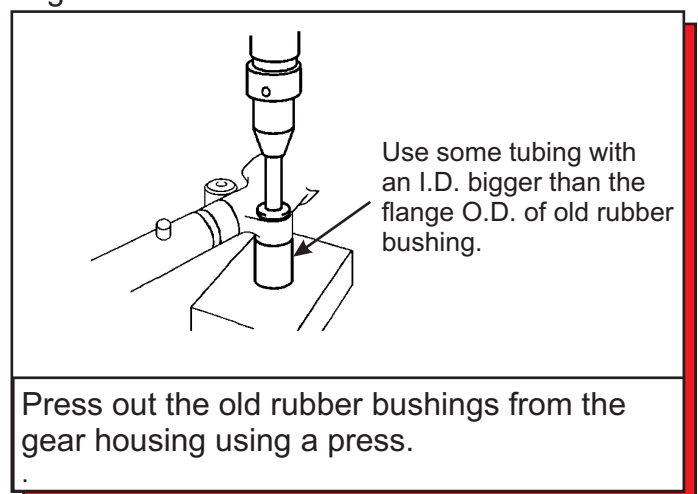

Fig. 3

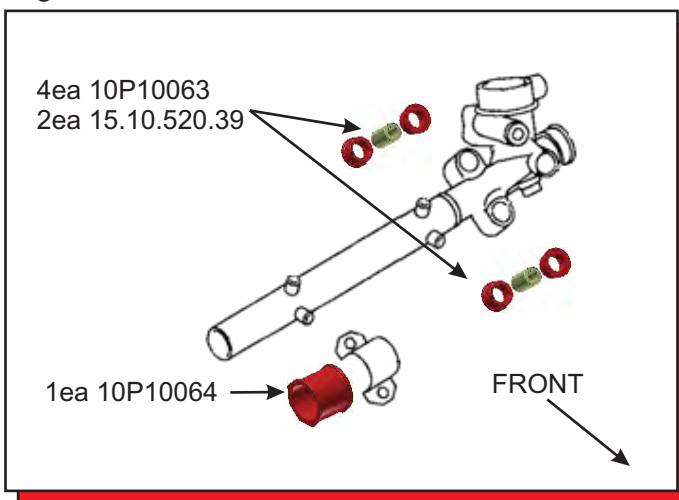

Fig. 4

