

## INSTALLATION INSTRUCTIONS

### 2014-2021 Kawasaki® Teryx™ 2-Seat Models

#### PART #901057

12 Pieces dimpled aluminum/glass fiber custom cut shields

1 - Piece insulating line sleeve

1 - Piece vinyl barrier / insulating custom cut piece

2 - Thumb screws

2 - Well nuts

4 - Self tapping screws with washers

#### NOTES:

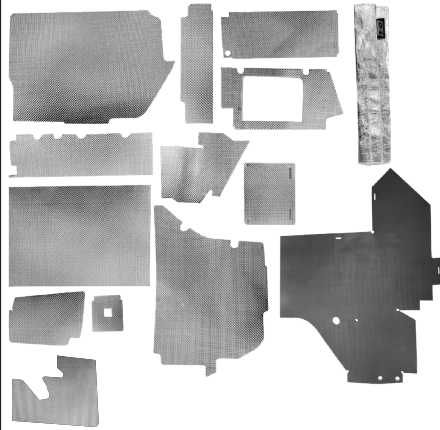

#### SURFACE PREP:

Vacuum or wipe down installation area to remove all loose debris/dust. Then clean with isopropyl alcohol to remove any contaminants.

Park on level ground and block wheels for safety

#### TOOLS:

Use manufacturer's suggested tools for panel removal.

Cleaner/Degreaser, Cloth, Side Cutters.

Drill with 1/2" bit



Fig. 1 - Remove driver seat bottom and disconnect seat belt warning connector

STEP 1. Remove the seat bases from both seats by unlatching and lifting the seat bases out.

STEP 2. On the driver side disconnect the seat belt warning wiring connector (Fig.1) and remove the 4 seat mounting bolts using a 12mm socket. These bolts have washers and spacers. Remove the seat. (Fig.2)

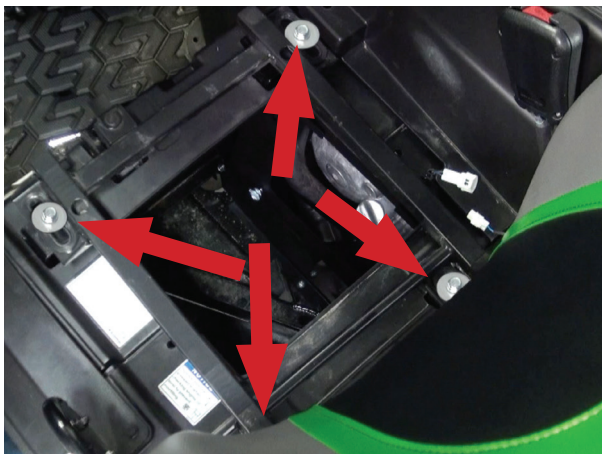

Fig. 2 - Remove 4 12mm bolts from driver seat bottom

STEP 3. On the passenger side remove the seat bottom and the 4 seat mounting bolts with a 10mm socket and remove the seat.



**Fig. 3 - Remove push pins from entire perimeter of center console. You can use tool as shown or a flat head screw driver to pop up the center of the push pin, then pull it out of the hole**

STEP 4. Remove the top of the center console by removing the push pins around the entire perimeter. Don't forget the front center pin that is in front of the cup holders. Lift the rear of the console first and remove the console. Having the parking brake lever partially raised will help in this process. This step will take some patience. (Fig 3 & Fig. 4)

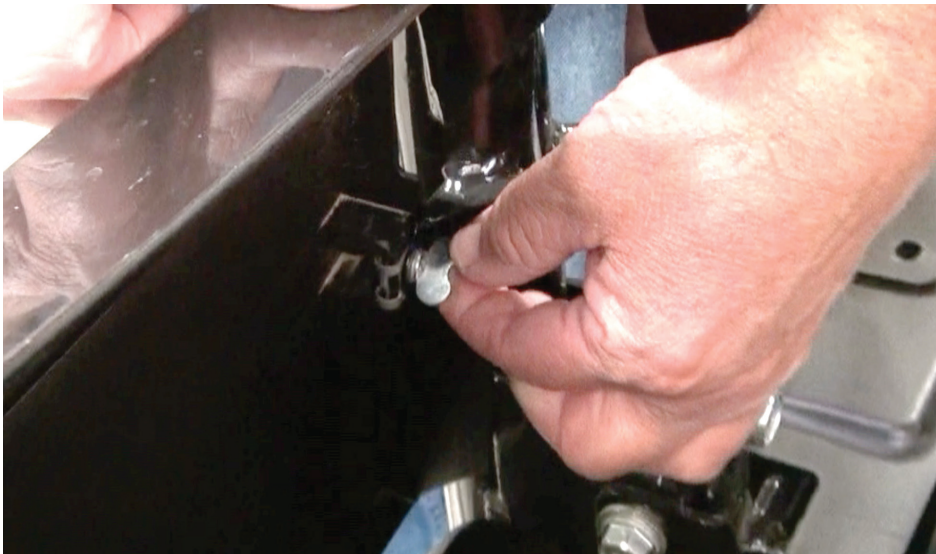

**Fig. 4 - After removing all push pins, even the ones in the foot well area, pull up on the back of the console, then lift up and toward the rear of the vehicle to help in removal. Also, engage the parking brake to help in removing the console. This will take some patience.**



**Fig. 5 - Remove all push pins on the top, front and side of trim panel under the driver seat. This piece extends all the way to the firewall in the foot well.**

STEP 5. Remove the push pins and the trim panel that extends from the console to the floor on the drivers side by removing all of the push pins. This panel is one large piece that goes under the drivers seat, extends down to the floor and forward to the firewall.(Fig. 5)



STEP 6. Tilt up the bed for clearance and remove the RH and LH body panels next to the storage bins. These can be removed by reaching inside the front of the panel and turning the 1/4 turn fastener and sliding the panel forward. (Fig. 6)

Fig. 6 - Turn thumb screw 1/4 turn and lift panels out



STEP 7. Remove the center piece of the cargo area by removing the 4 Phillips head screws. (fig 7)

STEP 8. There is an accessory power outlet on this panel. Remove the 2 wires noting their location for later. The wires and the outlet are marked + and - and need to be re-installed correctly later. (Fig 8)

Fig. 7 - Remove 4 screws from center panel between rear storage units & lift panel out



Fig. 8 remove 2 wires from accessory outlet. They are wired + & - and need to be reattached correctly later

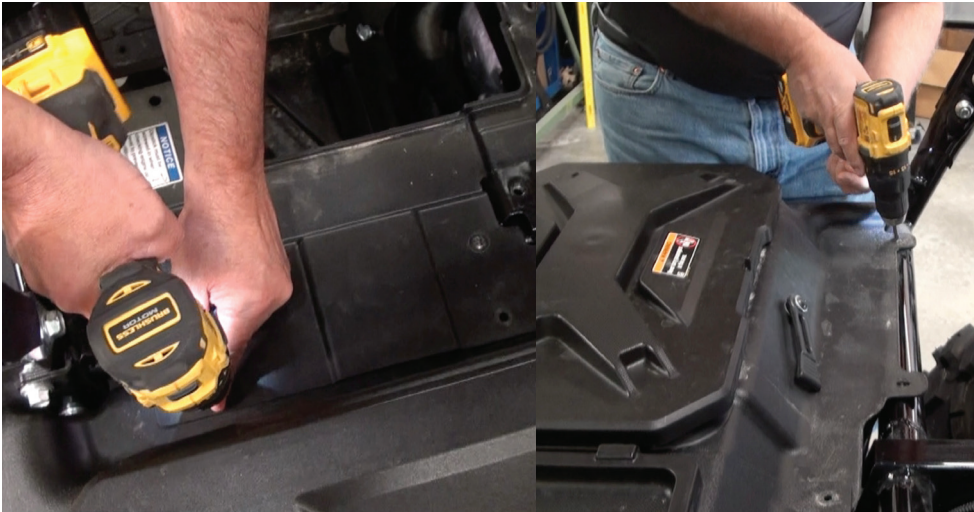

STEP 9. Remove the storage bins on both sides. There are longer Phillips head screws in the front (fig. 9) and shorter Phillips head screws in the rear of these bins. (Fig. 10)

**Fig. 9 - longer phillips head screws in front**

**Fig. 10 - shorter phillips head screws in back**

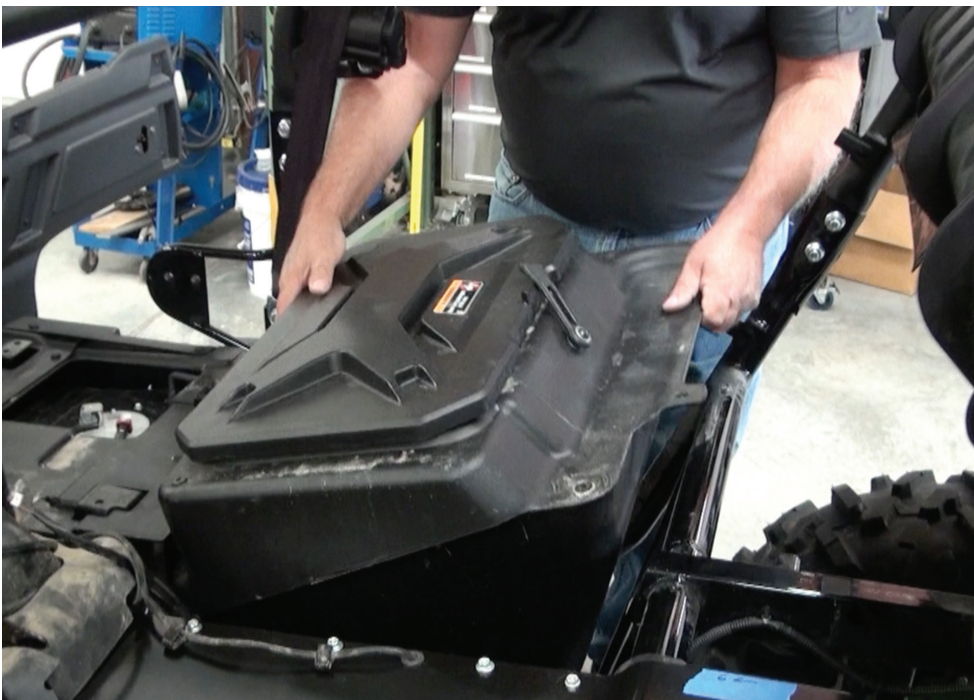

**Lift out both driver and passenger side storage bins**



STEP 10. Remove the rubber mat on top of the engine. This will not be reused. (Fig. 11)

**Fig 11 - Remove rubber mat on top of engine. This will not be re-used**



**Fig 12. Remove metal heat shield in the drivers foot well**

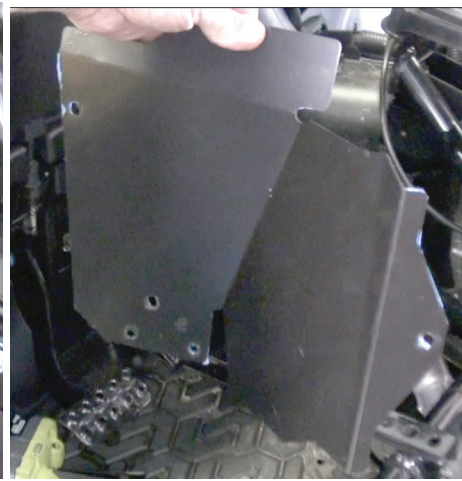

STEP 11. Starting at the driver side front remove the metal heat shield located near floor level with a 10mm socket. (Fig 12)

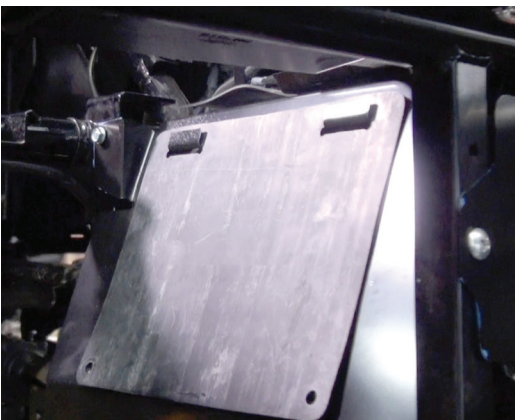

**Fig 13 - Remove metal heat shield under drivers seat. The piece with the rubber flap attached to it**



STEP 12. Remove the metal heat shield located under the drivers seat by removing the Phillips head screws and the mounting bolts. Note their locations for reassembly later. Remove the two push pins and the rubber sheet from this panel, these will not be reused. (Fig 13)

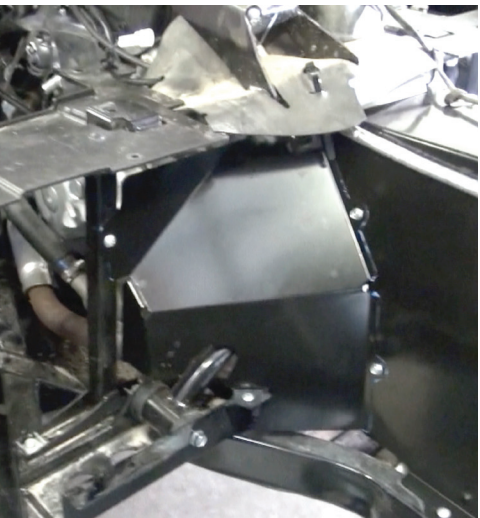

**Fig 14 - Remove the shield behind the drivers seat**



STEP 13. Remove the heat shield behind the drivers seat in the same manner. (Fig. 14)



STEP 14. Remove the small shield at the rear of the exhaust tunnel that is above the muffler. (Fig. 15)

**Fig 15 - Remove the top shield on the rear top of the exhaust tunnel.**

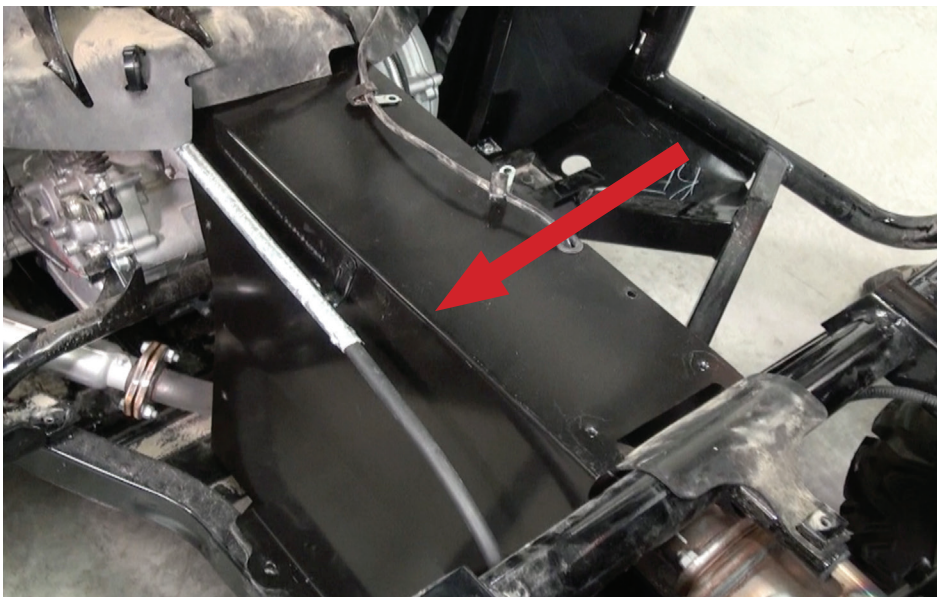

STEP 15. Remove the drivers side half of the exhaust tunnel. Note that the bolts on top of the tunnel have a washer under them. (Fig. 16) Also the Oxygen sensor wire extends up through this panel. Carefully slide the grommet and wire out of the panel. (Fig. 17) There is a shift cable outside this tunnel and will easily slip out of the cable support. (Fig 18)

STEP 16. Remove the passengers side of the exhaust tunnel. (Fig. 19)

**Fig 16 - Remove the driver side and top piece of exhaust tunnel. (one solid piece)**



**Fig 17 - Oxygen Sensor wire comes through top of panel. Slide grommet and wire out of this panel.**

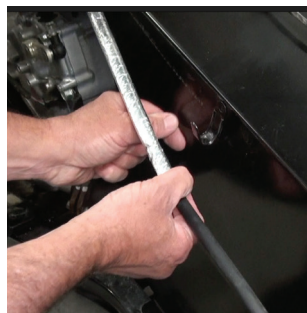

**Fig 18 - Shift cable is held in a bracket on the side of the tunnel piece, just lift cable out of bracket.**

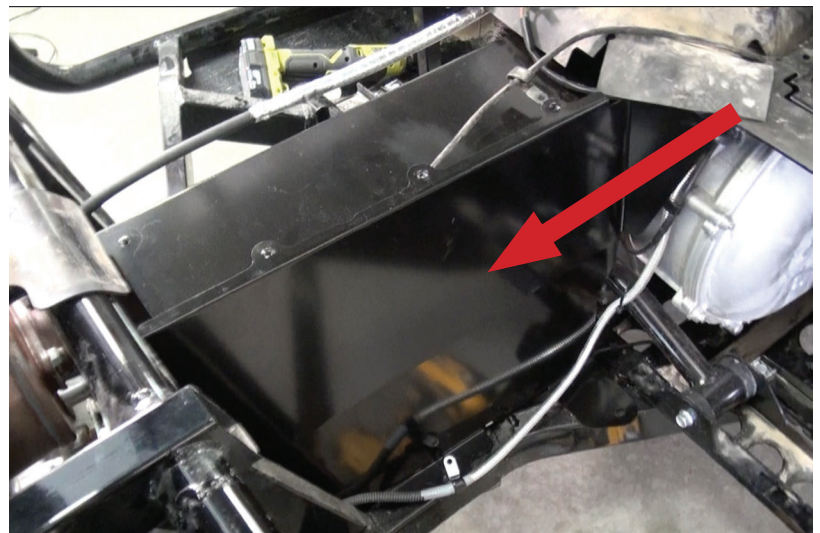

**Fig 19 - remove passenger side exhaust tunnel piece**

## INSTALLING THE PRE-CUT INSULATION:

**NOTE:** For proper installation and long life of the kit, the inside of these metal panels will need to be clean. Wash the panels with soap and water and dry thoroughly. Then wipe the inside of the panels with denatured alcohol or window cleaner and allow to dry.

**NOTE:** The adhesive is very aggressive and the insulation cannot be adjust after it is applied. When you have the part matched up remove a small amount of the backing sheet and apply the insulation to the panel. Then pull more of the backing sheet away and work your way across the panel attaching the insulation.

STEP 17. At this point we will you will be installing the insulating material to the inside of the panels. Starting with the shield that was closest to the front of the vehicle and insulation piece #1 form the insulation to the panel. Note that the entire panel may not be covered.

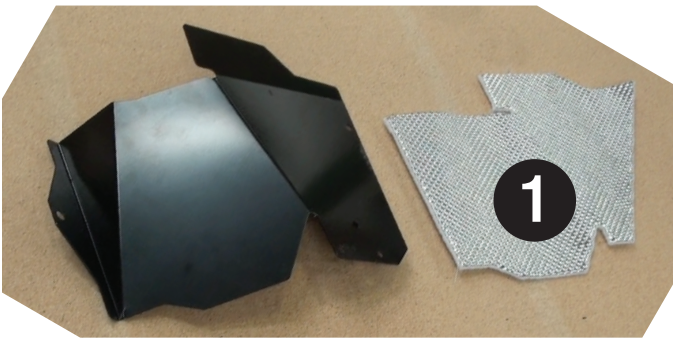

STEP 18. Working with the heat shield that goes under the drivers seat drill the 2 holes that had plastic push pins in them to 1/2". Insert 2 rubber well nut inserts into these holes from the outside of the panel.

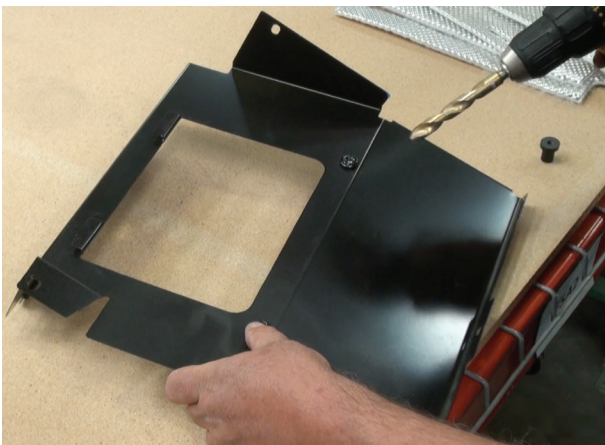

STEP 19. Locate insulation pieces #2, #3, and #4 that will be applied to the inside of this panel. Install each piece by removing a small amount of the backing sheet and working your way across the part.

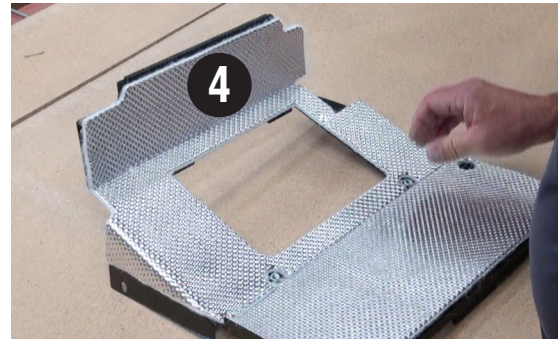
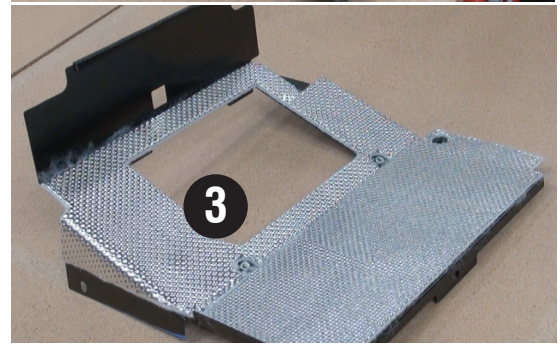
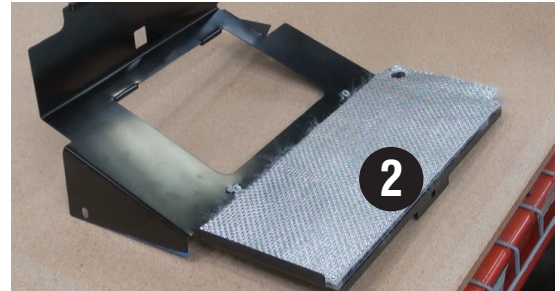
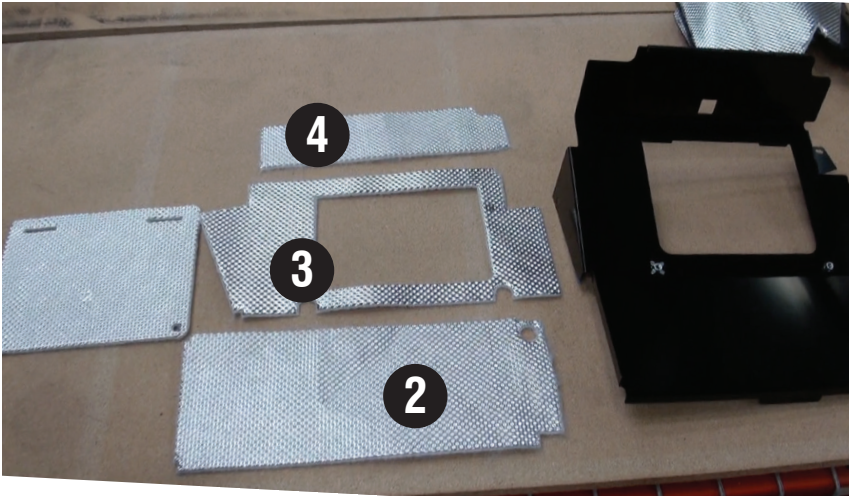

STEP 20. Locate Insulation piece #5, this will replace the rubber flap that was removed earlier. Hang this piece on the outside of the panel by the slots at the top and install two thumb screws with washers to hold it in place. This is removable so the oil can be checked.

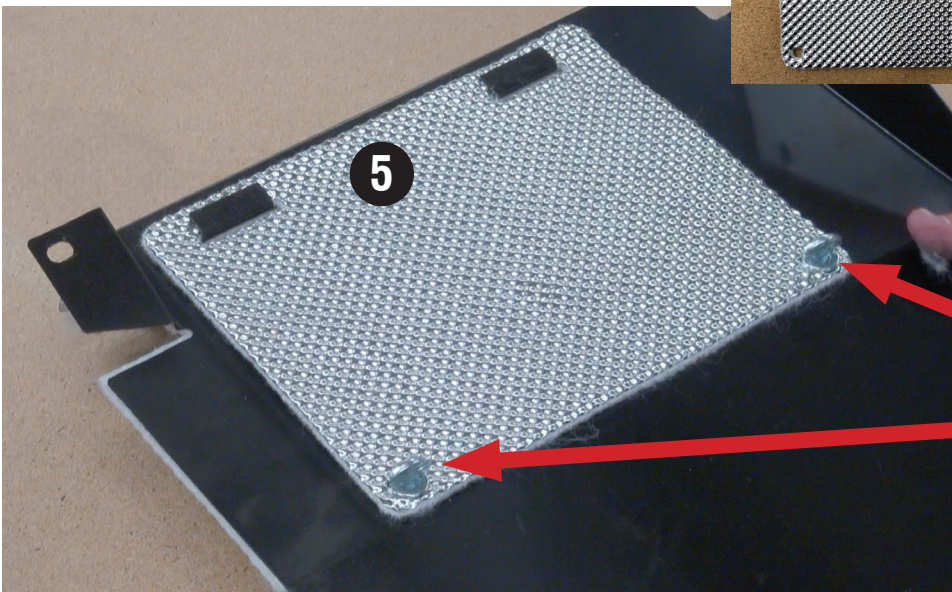

Close up of thumb screws with washers installed in two corners

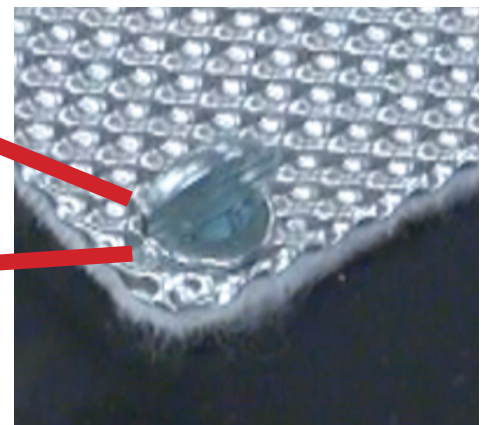



STEP 21. Heat shield that is behind the drivers seat – Apply insulation pieces #6 and #7

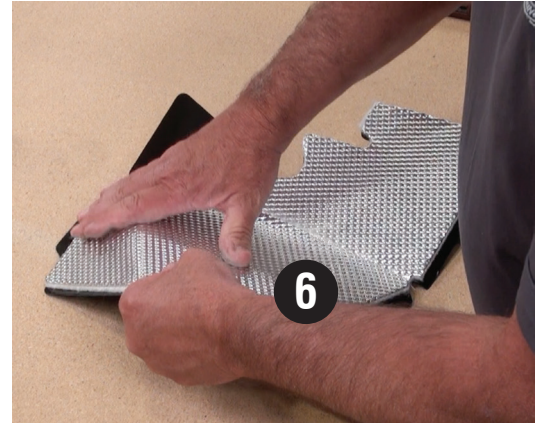
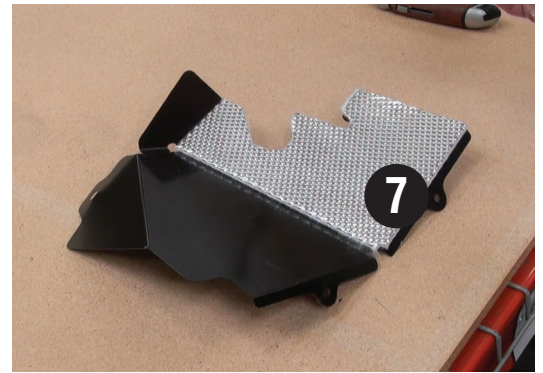
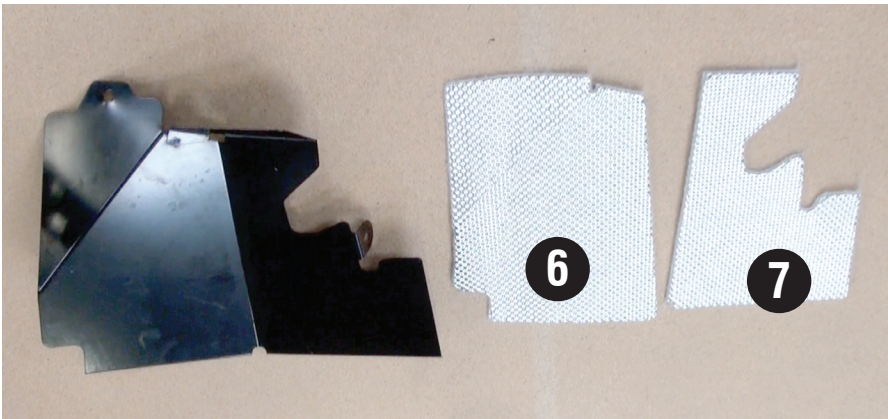

STEP 22. Drivers side of the exhaust tunnel – Apply insulation pieces #8 and #9



STEP 22 - Passengers side of the exhaust tunnel – Apply insulation piece #10

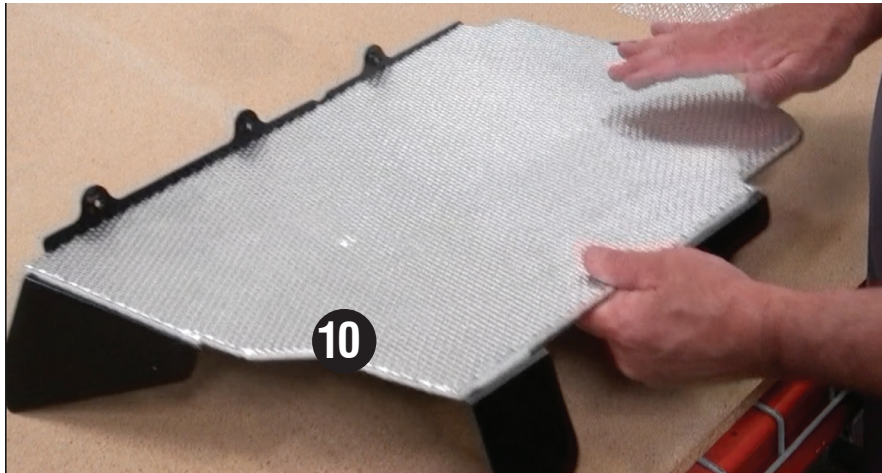
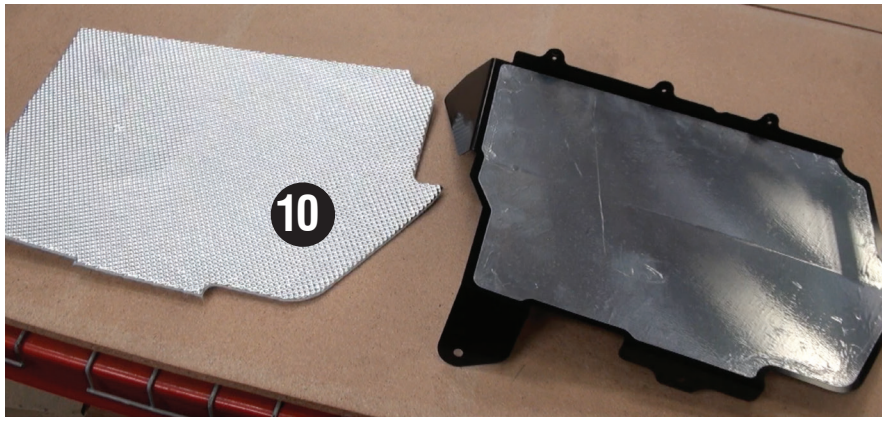

STEP 23. Small heat shield that was at the rear above the muffler – Apply insulation piece #11.

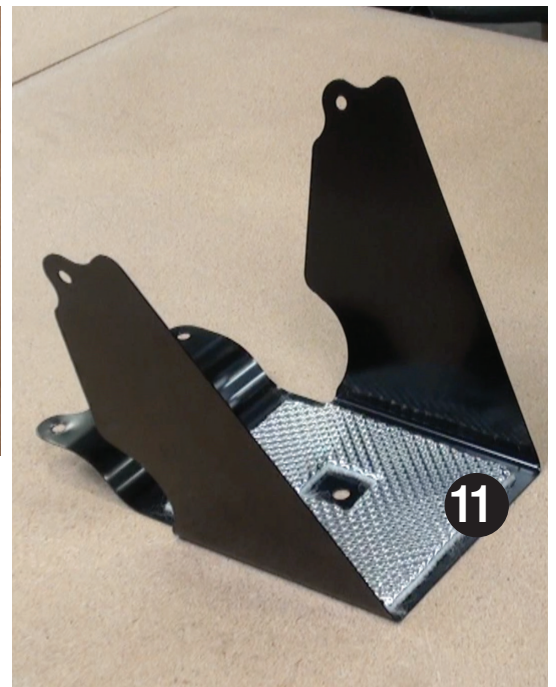
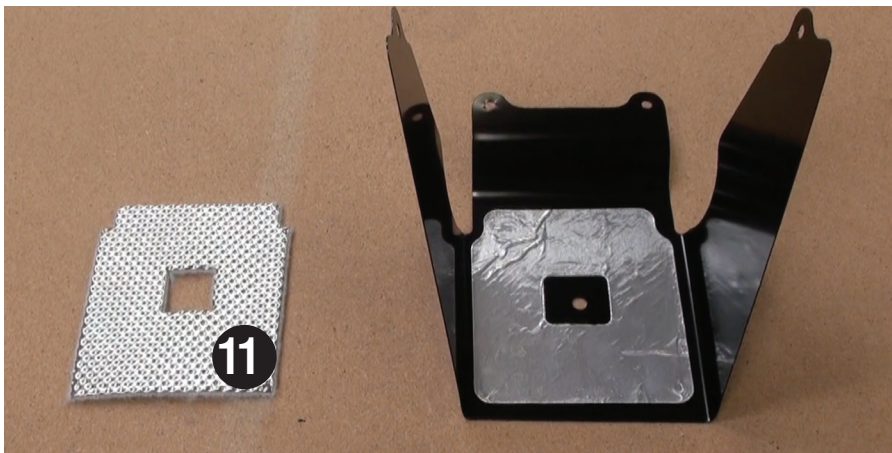



STEP 24. Install the insulating wrap #12 on the coolant lines on the drivers side. (Fig. 20)

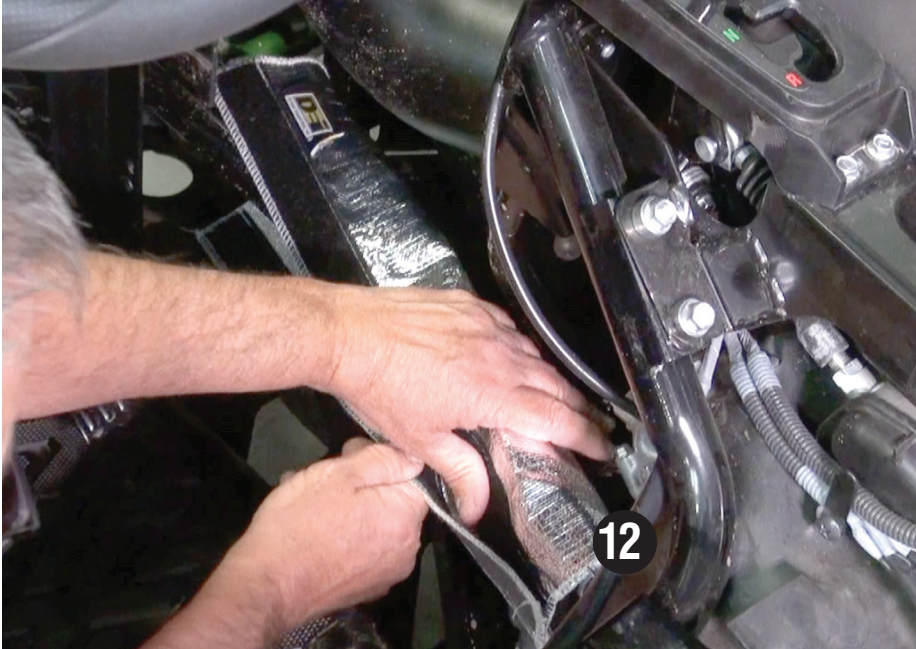
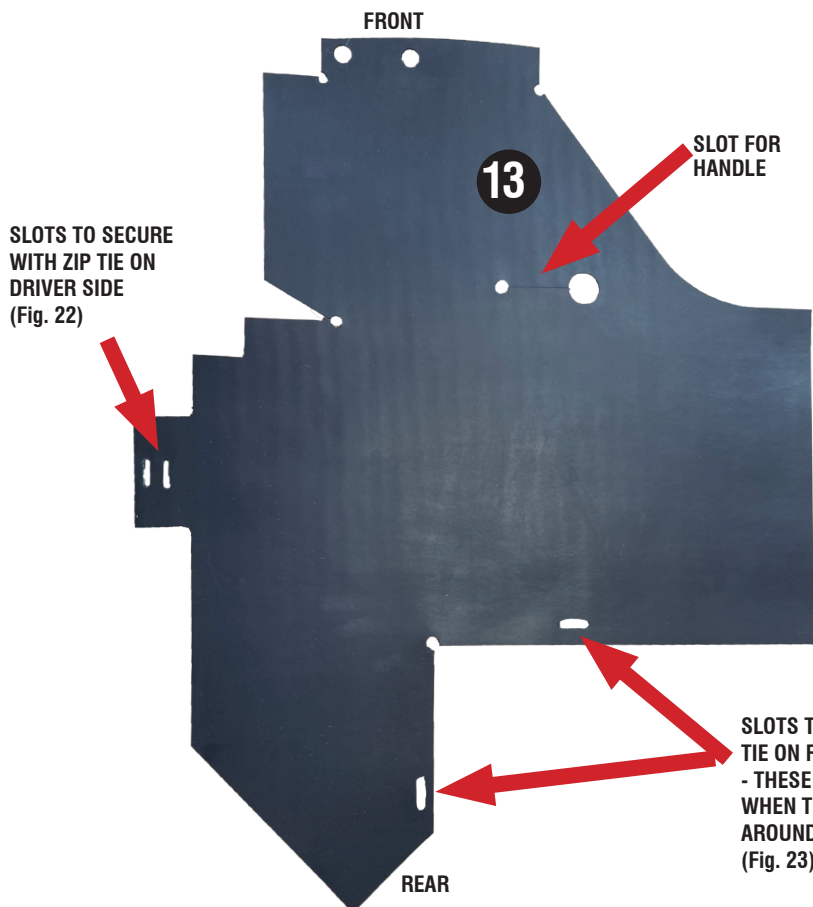
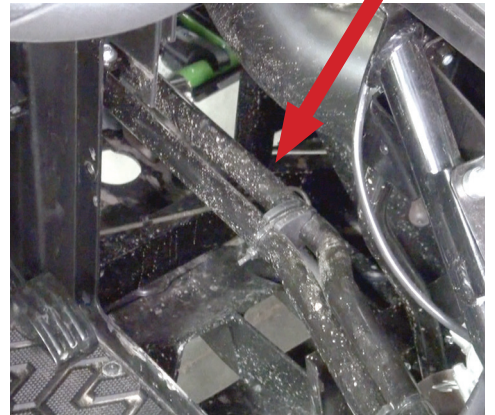

Fig 20 - Wrap these lines. Make sure hook and loop closure is facing away from exhaust



STEP 25. Install #13 the insulated rubber mat on top of the engine, white insulation side down against the engine. (Fig. 21) Secure the Drivers side with one zip tie (Fig. 22) then install one zip tie loosely to the rear slots to form the mat around the rear. (Fig. 23) Make sure the front edge of this is not on top of the metal bar as this will not allow the console to seat properly when installed. (See note in Fig. 21)

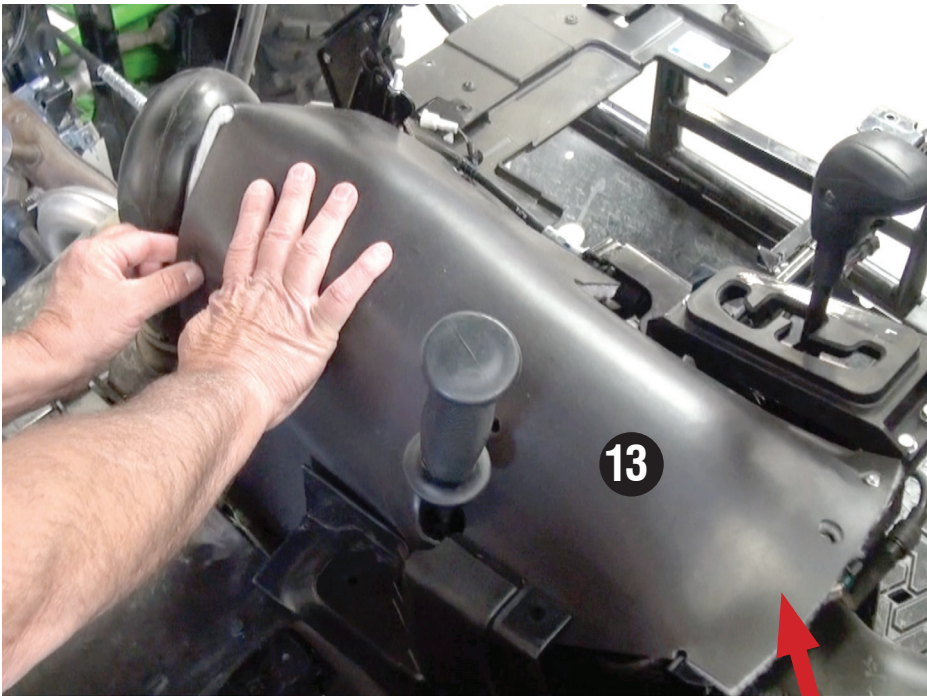

Fig 21 - Install mat on top of engine. (View from passenger side front of vehicle)

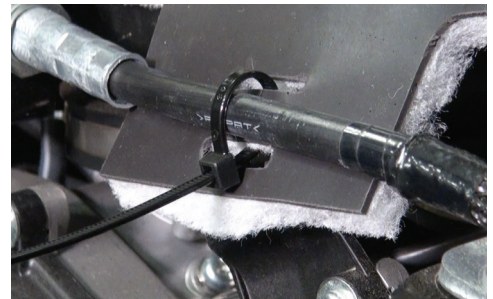

Fig 22 - Secure driver side through slots with zip tie



Fig 23 - Secure rear through slots with zip tie

This front flap goes under metal support bar so the console seats properly. It is shown above the bar in the photo

STEP 26. Install #14 the cargo bed heat shield by sliding it between the bed release bar and the bottom of the bed. (Fig. 24)  
Attach with two self tapping bolts and washers in each of the cross bars. (Fig. 25)



Fig 24 - Slide shield between bed and bed release bar

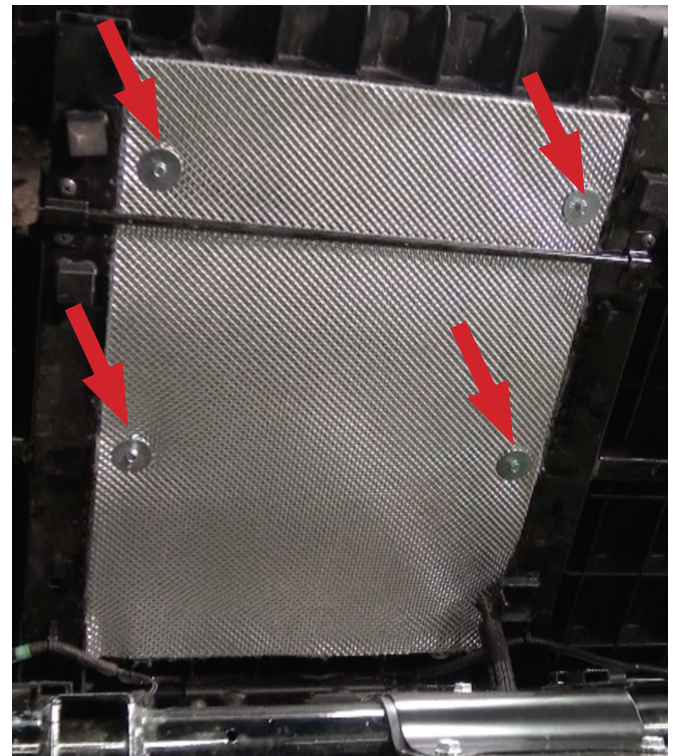

Fig 25 - Secure shield with self tapping bolts and washers into the two cross bars

## REINSTALL PANELS

STEP 27. Now working front to rear install the 6 metal heat shields back into the vehicle. You may want to leave the hardware loose until all of the shields are lined up and in place. When working with the exhaust tunnel remember to insert the grommet and Oxygen sensor wire, and that the 3 bolts on the top of the tunnel are the ones with washers. Tighten the hardware on all of the metal panels.

STEP 28. Install the two storage bins using the Phillips head screws.

STEP 29. Install the center piece of the cargo area being sure to properly reattach the power and ground to the proper terminals. Then secure the panel with 4 Phillips head screws.

STEP 30. Install the lower drivers side interior panel with push pins. Note this panel has a slot in the front on top that will mate to the tab in the panel under the dash.

STEP 31. Install the LH exterior panel using push pins.

STEP 32. Install the center console noting that the front of the console has tabs on each side that will slip into the lower panels as you are installing. Again this will take some patience and a helper can make this easier. Reinstall the push pins around the perimeter.

STEP 33. Install the RH and LH body panels next to the storage bins. Lubricate the grommets with some silicone spray or suitable lubricant to allow them to slide into place easily. Be sure to connect the ¼ fasteners securely.

STEP 34. Reinstall the drivers seat with the 12mm head bolts, spacers, and washers. A drop of blue Thread Locker is recommend on all 8 of the seat mounting bolts. Reconnect the seat belt warning wire and install the seat base.

STEP 35. Reinstall the passengers seat with the 10mm head bolts, and install the seat base.