



IMPORTANT WARRANTY & INSTALLATION
INSTRUCTIONS ATTACHED

*Please Forward All Attached Information to Consumer
Warranty Not Valid Unless Returned to CORSA Exhaust*

We ask that you take a few moments to complete our warranty registration form:

TO ACTIVATE YOUR LIMITED LIFETIME WARRANTY GO TO:
CORSAPERFORMANCE.COM/WARRANTY



**For Full-Color Installation Instructions, Please Visit:
CORSAPERFORMANCE.COM and Search by Part Number**

Please be sure to review the enclosed instructions prior to beginning the installation process. If you have any questions about the enclosed parts, instructions or encounter a problem during installation:
CALL CORSA PERFORMANCE TECHNICAL ASSISTANCE AT 800.486.0999

Please take time to read and understand these installation instructions.

CORSA recommends that the installation of this system be performed by a qualified service center or professional muffler installer who has the necessary equipment, tools and experienced personnel. However, if you decide to perform this install, the use of a hoist and an additional person will be required.

CAUTION: Never work on a hot exhaust system. Allow time for the vehicle to cool. Always wear eye protection when working under a vehicle.

Recommended Tools:

- 3/8" drive ratchet
- 3/8" drive 13mm deep socket
- 3/8" drive 15mm deep socket
- 3/8" drive 1/2" deep socket
- 3/8" drive 3" extension
- 3/8" drive 6" extension
- 1/4" drive ratchet
- 1/4" drive 7mm socket
- Safety glasses
- T30 torx bit socket or screwdriver
- Chain-style pipe cutter
- Grommet pullers
- Soap and water solution
- Permanent Marker
- Tape measure
- Torque Wrench
- Penetrating lubricant spray

Please confirm that all parts are present before beginning the factory exhaust system removal and CORSA exhaust system installation.

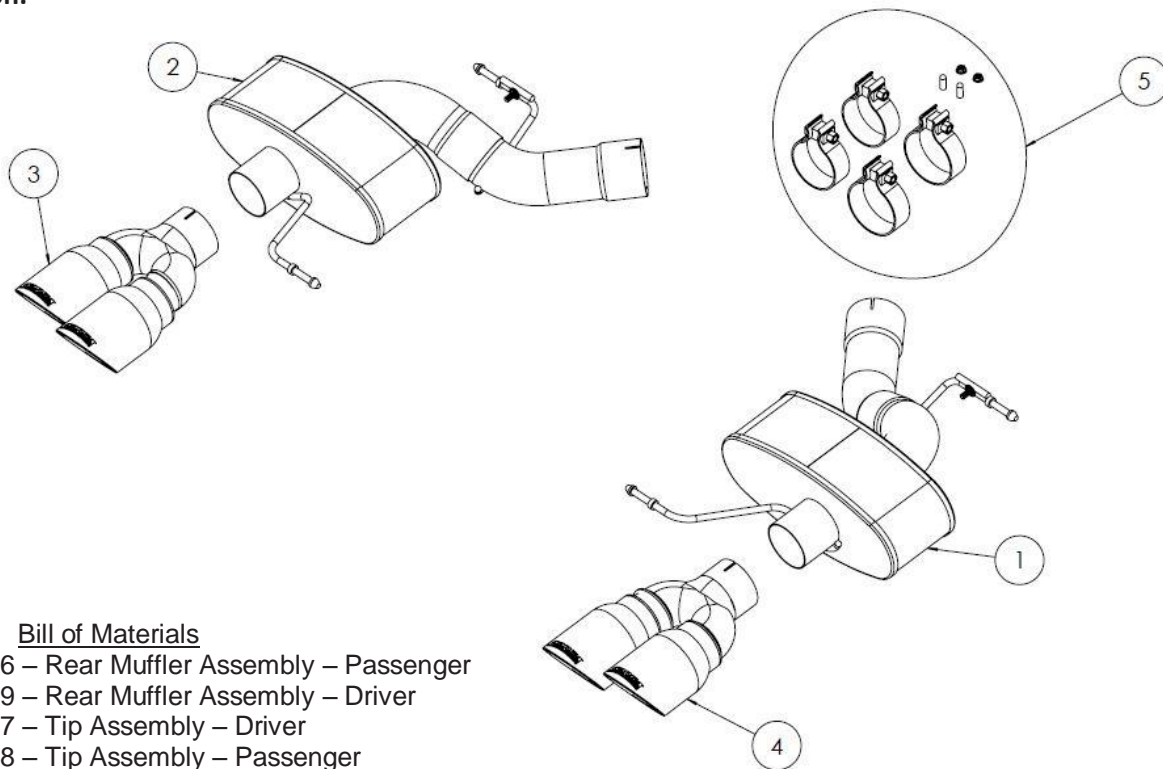

Bill of Materials

1. 13MV2056 – Rear Muffler Assembly – Passenger
2. 13MV2059 – Rear Muffler Assembly – Driver
3. 13MV3007 – Tip Assembly – Driver
4. 13MV3008 – Tip Assembly – Passenger
5. 13MV7055 – Hardware Kit

Factory Exhaust System Removal:

1. Remove plastic splash guard from the rear of the vehicle using the T30 Torx driver, 7mm socket and 1/4" ratchet. The T30 Torx fasteners are along the back side near the bumper while the 7mm hex head fasteners are placed around the edges and sides of the shield. **(Fig. A)**
2. Locate the small dent in the driver's side exhaust piping near the aluminum and plastic splash guards covering the rear differential. The dent is located on the bottom of the pipe close to the rear edge of the splash guard. Measure 1.25" from this dent towards the rear of the car and mark the pipe. **(Fig. B)** Repeat this step on the passenger's side of the vehicle.
3. Using the chain-style pipe cutter or other appropriate device, cut the pipe at the mark. **(Fig. C)** Repeat this step on the passenger's side of the vehicle.
4. Locate the vacuum line and vacuum actuator on the outer tip on the driver's side rear muffler. Remove the vacuum line from the actuator **(Fig. D)** and cap with one of the supplied vacuum caps. **(Fig. E)** Tuck the capped vacuum line between the heat shield and frame of the vehicle. **(Fig. F)** Repeat this step on the passenger's side of the vehicle.
5. Using the ratchet and the 13mm deep socket, remove the nut securing the ground strap to the rear stud of the front hanger. Remove only the rear-most nut at this time. **(Fig. G)** Repeat this step on the passenger's side of the vehicle. Keep the nuts for use during the Corsa system installation.
6. Using the ratchet, 6" extension and the 13mm deep socket, remove the nut securing the rear hanger to the vehicle. **(Fig. H)** Repeat this step on the passenger's side of the vehicle. Keep the nuts for use during the Corsa system installation.
7. **NOTE:** The only thing supporting the muffler at this time is the hanger at the front of the muffler. Take care as to not let the muffler swing and damage the car and to prevent personal injury.
8. Remove the remaining nut securing the front hanger. Repeat this step on the passenger's side of the vehicle. Keep the nuts for use during the Corsa system installation.
9. Remove the factory mufflers from the vehicle.
10. Using the ratchet and 13mm deep socket, remove the nut securing the ground strap to the rear muffler's hanger. **(Fig. J)** Repeat this step for both mufflers. Keep the ground straps for use during the Corsa exhaust system install. The nuts are not used during the later installation of the Corsa system.
11. Using grommet pullers or a similar device, remove the front hanger and hanger grommet from the muffler. **NOTE:** The use of a soapy water solution may aid in the removal of hanger grommets. **(Fig. K)** Keep the hangers and hanger grommets for use during the Corsa system installation.
12. Using grommet pullers or a similar device, remove the rear hanger and hanger grommet from the muffler. **NOTE:** The use of a soapy water solution may aid in the removal of hanger grommets. **(Fig. L)** Keep the hangers and hanger grommets for use during the Corsa system installation.

REMOVAL PICTURES ON NEXT PAGE 

Factory Exhaust System Removal Pictures:



Fig. A



Fig. B



Fig. C

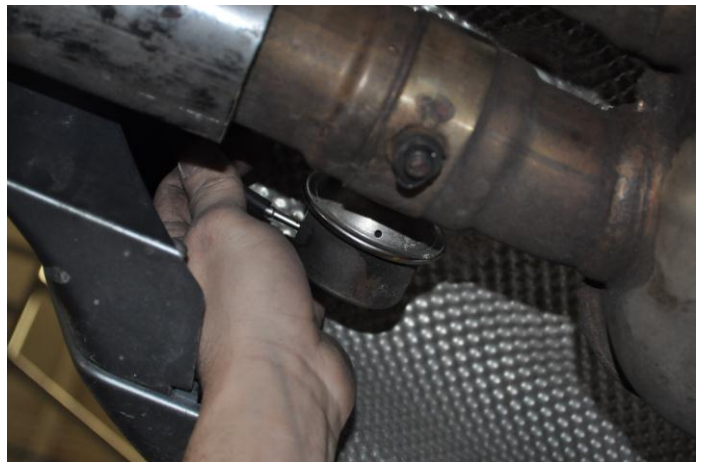

Fig. D



Fig. E



Fig. F

Factory Exhaust System Removal Pictures:



Fig. G

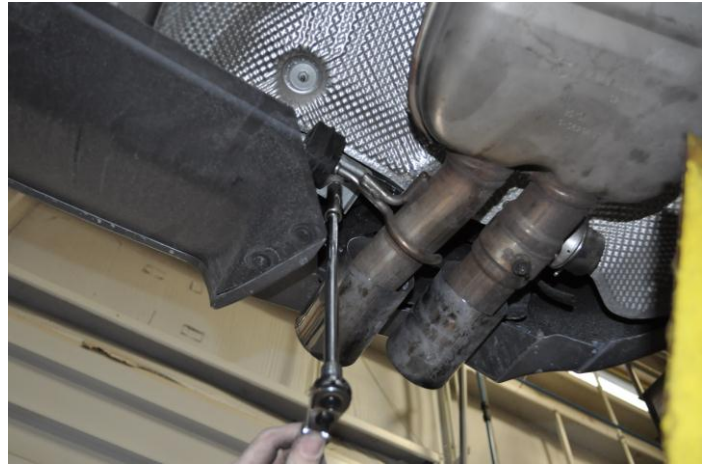

Fig. H



Fig. J



Fig. K

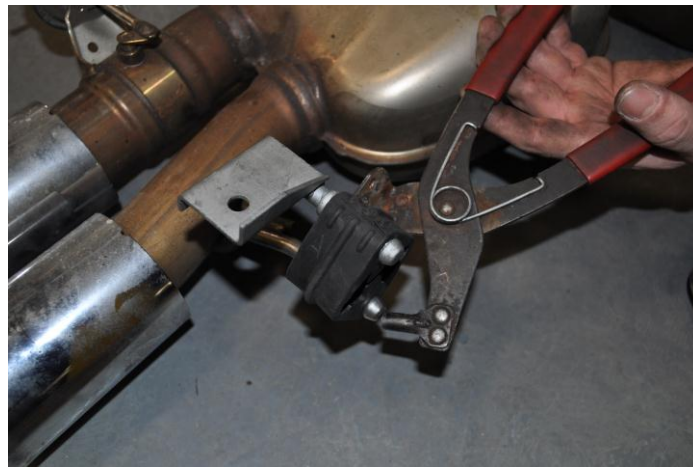
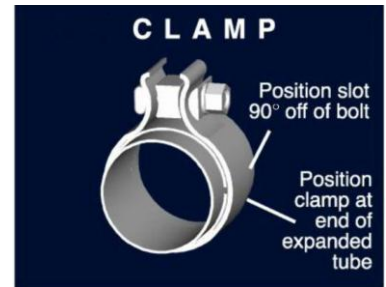

Fig. L

Installation of CORSA Exhaust System:

NOTE: Apply the anti-seize lubricant (supplied) to the threads **ONLY** of all the clamps and flange bolts. Failure to follow this procedure can cause nuts to seize on clamps and potentially destroy threads. After applying anti-seize lubricant, be sure to thoroughly clean your hands, as lubricant will tarnish stainless steel. All clamps should be tightened using a properly calibrated Torque Wrench. Using an air impact gun will damage the clamp and reduce its ability to effectively seal the joint. It may also cause the joint to separate, thereby causing damage to your exhaust system and to your vehicle.

NOTE: Align all clamps so that the center of the clamp bolt is 90 degrees from the notch in the pipe. (See Fig. CLAMP)



1. Remove all exhaust system components from the shipping box, including clamps and hardware.
2. Locate the driver's side muffler assembly and the front hanger removed during Step #10 of the removal process. **(Fig M)** Slide the rubber grommet onto the front hanger of the muffler assembly. **(Fig. N and P)**
Note: The use of a soap and water solution may make it easier to install hangers.
3. Repeat Step #2 on the passenger's side muffler.
4. Locate the rear hanger removed during Step #11 of the removal process. Slide the rubber grommet onto the rear hanger of the muffler assembly. **(Fig. Q and R)**
Note: The use of a soap and water solution may make it easier to install hangers.
5. Repeat Step #4 on the passenger's side muffler.
6. Locate one of the 80mm clamps. Slide it over the end of the expanded muffler inlet, noting the location of the clamp's bolt and the notches on the expansion. Be sure to have the bolt towards the inside of the car. **(Fig. S)** Slide the expanded end of the muffler assembly over the cut end of the factory exhaust. **(Fig. T)** Do not tighten the clamp at this time.
7. Locate one the nuts removed during Step #7 of the removal process. Using the 13mm deep socket, 6" extension and ratchet, tighten the nut onto the front stud to secure the front hanger supporting the driver's side muffler. **(Fig. U)**
8. Repeat Step #7 on the passenger's side muffler.

INSTALLATION INSTRUCTIONS CONTINUED ON NEXT PAGE



9. Locate one of the nuts and one of the ground straps removed during Steps #4 and #9. Using the 13mm deep socket, 3" extension and ratchet, secure the ground strap to the rear stud of the front hanger. Orient the strap so that the eyelet is end is pointing towards the inside of the vehicle. **(Fig. V)**
10. Repeat Step #9 on the passenger's side of the vehicle.
11. Using the ratchet and 1/2" deep socket, secure the ground strap to the stud on the muffler hanger using one of the nuts supplied with the Corsa kit. **(Fig. W)**
12. Repeat Step #11 on the passenger's side of the vehicle.
13. Locate one of the nuts removed during Step #5 of the removal process. Using the 13mm deep socket, 6" extension, and ratchet, secure the rear hanger on the driver's side muffler. **(Fig. X and Y)**
14. Repeat Step #13 on the passenger's side of the vehicle.
15. Locate the driver's side tip assembly and one of the 3" clamps. Install the clamp onto the tip assembly such that the bolt is vertical with the nut towards the ground and the bolt is towards the outside of the car. Tighten the clamp using the ratchet and 15mm deep socket until the tip assembly is snug on the muffler's outlet pipe. **(Fig. Z and AA)**
16. Using the 15mm deep socket and ratchet, snug the clamp on the inlet of the muffler. **(Fig. BB)**
17. Repeat Step #16 on the passenger's side of the vehicle.
18. Adjust the system accordingly so that the tips are centered in the bumper valence. At this time, tighten all clamps to 45ft-lbs using the torque wrench and 15mm socket. Take note when adjusting the system to maintain a finger tip's gap between the hanger and hanger bracket on the front hanger. **(Fig. CC)**
19. Reinstall the plastic splash guard using the fasteners retained from Step #1 of the removal process. The Torx fasteners are used along the edge of the bumper while the hex head fasteners secure the guard along the edges with two in the middle. **(Fig. DD)**

NOTE: During cold weather start-ups, you may experience an exhaust sound that is deeper and louder in tone than usual. This is temporary and will diminish to normal levels once your engine has reached its normal operating temperature.

NOTE: Immediately following the installation of your exhaust system, you may experience a trace of smoke after initial start-up. DO NOT be alarmed. The smoke is caused by the burning of a small amount of forming oil residue used in the manufacturing process.

INSTALLATION PICTURES ON NEXT PAGE 

CORSA Installation Pictures

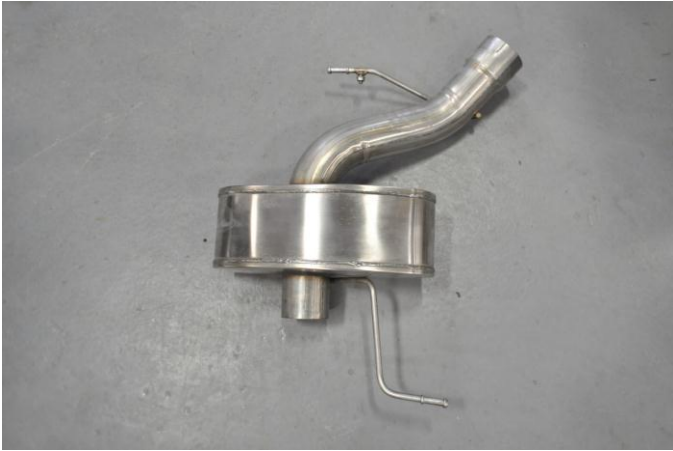

Fig. M



Fig. N



Fig. P



Fig. Q



Fig. R



Fig. S

CORSA Installation Pictures

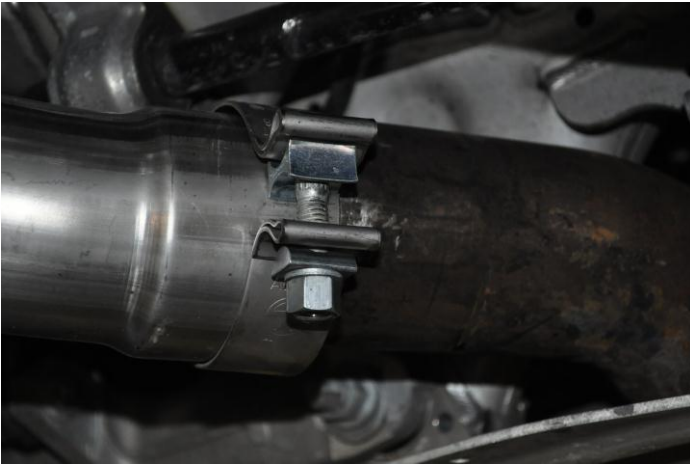

Fig. T



Fig. U



Fig. V



Fig. W



Fig. X



Fig. Y

CORSA Installation Pictures

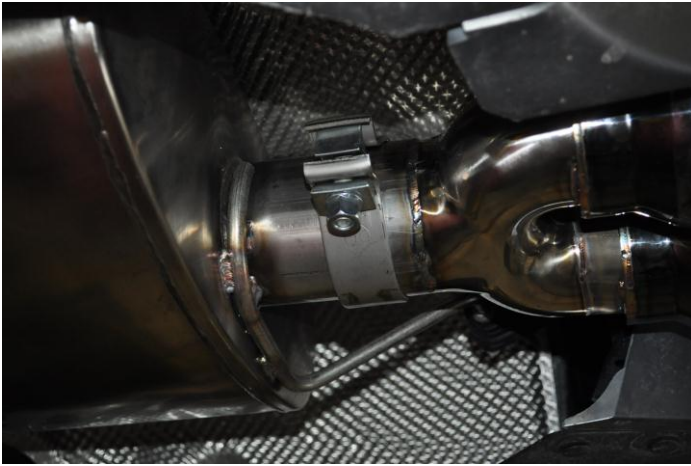

Fig. Z



Fig. AA



Fig. BB



Fig. CC



Fig. DD