

Intake Kit Installation Instructions: 2009-2014 VW Jetta TDI, L4-2.0L TDI; 2010-2013 Audi A3, L4-2.0L TDI; 2010-2014 VW Golf, L4-2.0L TDI; 2012-2014 VW Passat, L4-2.0L TDI; 2013-2014 VW Beetle, L4-2.0L TDI



advanced FLOW engineering™
P.O. Box 1719
Corona, CA 92878
Support: 951-493-7100
aFepower.com

Kit Part #	51/54/75-81711 Stage 1		Tools Required:	Part List:		
Make:	Volkswagen, Audi		5/16" nut driver or slotted screwdriver	1 Air Filter <i>P5R</i> 24-35507 or <i>PDS</i> 21-35507		
Model	Year	Engine	Phillips screwdriver	1 Tube, Intake		
Jetta	2009-2014	2.0L TDI	1/2" open end wrench	1 Cover		
Audi A3	2010-2013	2.0L TDI	Medium size pliers	1 Coupling (05-01106)		
Golf	2010-2014	2.0L TDI		2 Clamp #048		
Passat	2012-2014	2.0L TDI		4 Screws, 1-1/2"		
Beetle	2013-2014	2.0L TDI		1 Trim-seal 21.25"		
				1 Nipple, Brass 3/8" x 1/4"		



Complete stock intake.



Remove the (8) screws holding the stock cover to the housing.



Disconnect the MAF sensor and unplug the breather tube that are located on the top side of the stock intake tube.

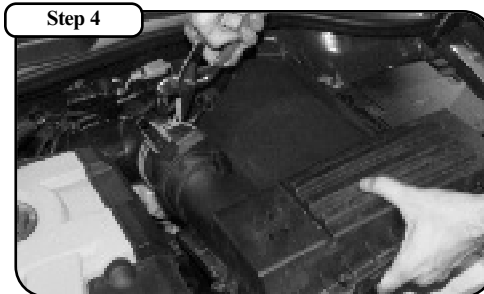

With a pair of pliers, loosen the clamp holding the tube to the MAF sensor to the stock intake tube and remove the cover and sensor from the vehicle.

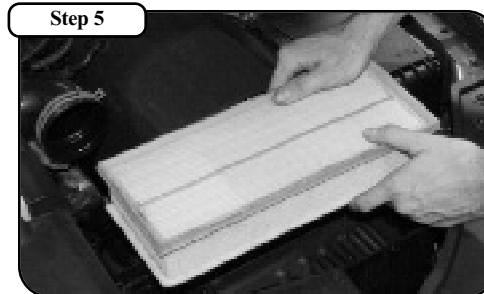

Remove the stock air filter and plastic grill from the factory air box.



Using a phillips screwdriver, remove the MAF sensor from the stock cover.



Re-insert the MAF sensor into the stock intake tube.

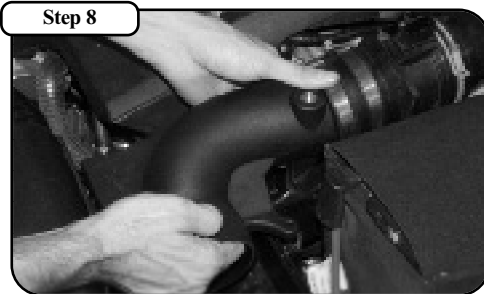

Insert the aFe intake tube along with the coupling and clamps onto the MAF sensor. Secure the intake tube using the provides screws.

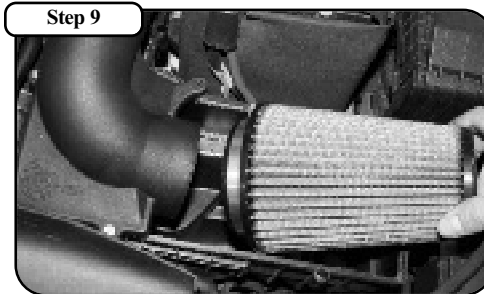

Install the aFe air filter onto the aFe intake tube.

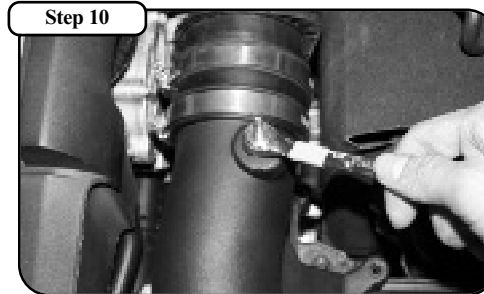

Tighten the Brass Nipple using either a box wrench or a deep socket.

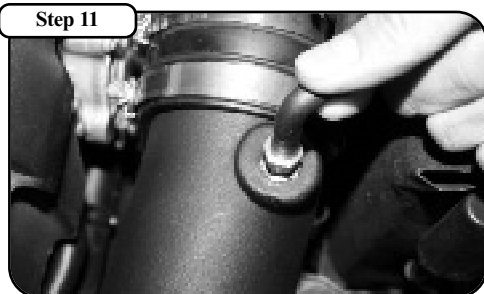

Push the breather tube onto the brass nipple. The special fitting does not require a clamp.



Tighten all clamps.

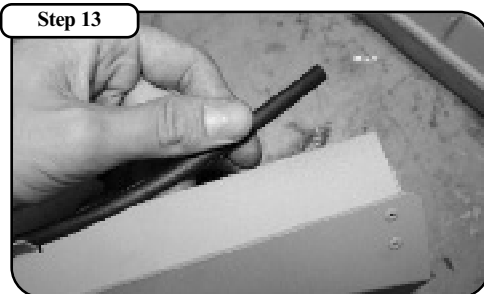

Place trim seal on the bottom side of the intake cover.

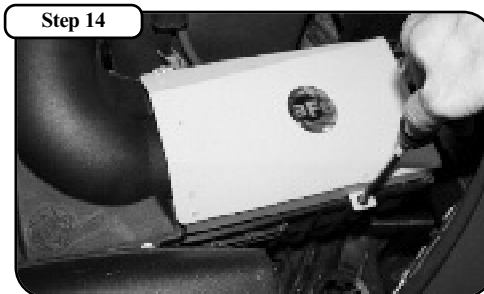

Secure the cover to the housing by tightening two of the stock screws using a phillips screwdriver. Use one of the screws provided for the tab that sits on the intake tube.



Your Stage 1 Intake is now complete. Make sure to tighten all clamps and check all electrical connections. Thank you for choosing aFePower!
NOTE: Retighten all connections after approximately 100-200 miles.

Note: Filter Cleaning and Re-oiling: When cleaning your aFe filter, be sure to use only aFe's "Restore Kit" (aFe P/N: 90-50001 blue oil aerosol, aFe P/N: 90-50501 blue squeeze bottle oil, or aFe P/N: 90-59999 Pro-Dry S Cleaner)
Filter Replacement: Magnum FLOW P/N: **Pro-5R**™#24-35507 (black w/blue media) or **Pro Dry S**™#21-35507 (black w/white media)