



# INSTALLATION INSTRUCTIONS

Cat-Back Exhaust

MAKE: Audi  
 MODEL: A4 B9 TFSI  
 YEAR: 2017-2019  
 ENGINE: 2.0L (t)

49-36420-P  
 49-36420-B  
 49-36420-C

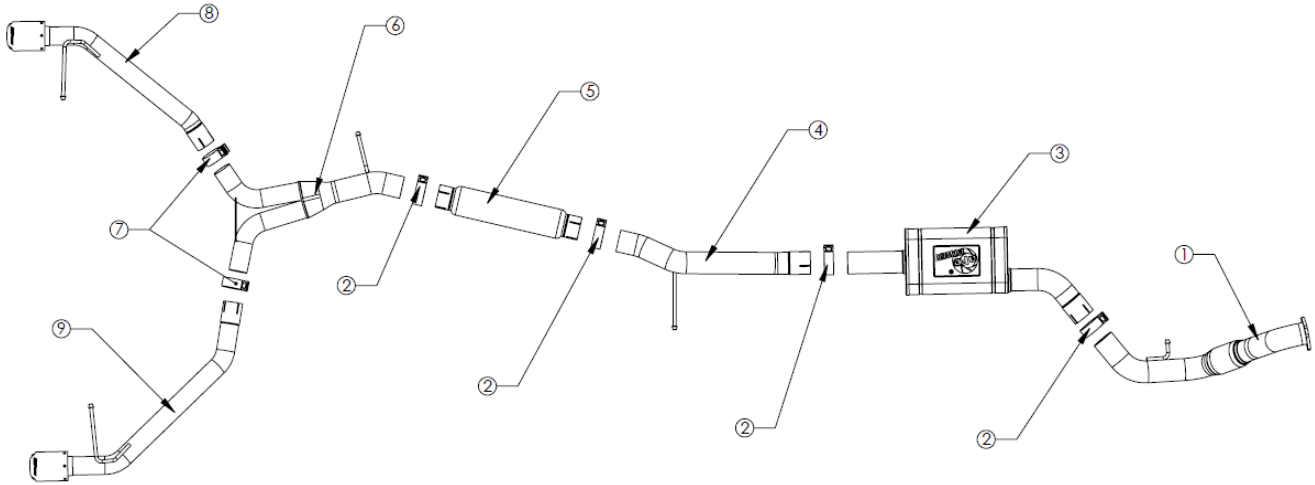

Item	Description	Part Number	Quantity
1	Up-Pipe Assembly	05-145811	1
2	3" Band Clamp	05-41055	4
3	Muffler Assembly	05-145812	1
4	Mid-Pipe Assembly	05-145813	1
5	Resonator: 3"	49M10001	1
6	Y-Pipe Assembly	05-145814	1
7	2-1/2" Band Clamp	05-41061	2
8	Driver Side Tailpipe	05-145816B	1
		05-145816P	
		05-145816C	
		05-145815B	
9	Passenger Side Tailpipe	05-145815P	1
		05-145815C	

aFe POWER recommends professional installation on this product. Thoroughly inspect the aFe POWER exhaust system to make sure there is no damage from shipping (if damage is noted, immediately contact aFe POWER customer service). Allow time for your vehicle to cool down prior to installation. When working on your vehicle proceed with caution. Wear protective safety equipment; eye goggles and gloves to ensure a safe installation.

Install band clamps to proper torque specifications of 40-45 ft-lb.





## INSTALLATION INSTRUCTIONS

**MAKE:** Audi  
**MODEL:** A4 B9 TFSI  
**YEAR:** 2017-2019  
**ENGINE:** 2.0L (t)

**Cat-Back Exhaust**

49-36420-P  
49-36420-B  
49-36420-C

1. **(Read instructions prior to installation.)** It is recommended to not fully tighten the exhaust until it has been fully installed. Leave loose for adjustability.
2. Secure vehicle on jack stands (refer to your manual for specified jack stand positions).
3. For faster installation, spread out the parts of the exhaust alongside your vehicle as shown in the diagram above.
4. Secure the stock exhaust with jack/stands.
5. Remove the center brace by loosening the (x4) 10mm 12-Point bolts.
6. Loosen the (x2) 15mm nuts on the 2.5" OE Sleeve Clamp.
7. Remove the (x2) OE hanger rods from the isolation mounts located on the OE Resonator.
8. Remove the (x2) OE hanger rods from the isolation mounts located on each tail-pipe muffler.
9. Remove the OE Axle-Back exhaust.
10. Open the hood and remove the OE engine cover.
11. Remove the (x3) 12mm nuts on the OE Up-Pipe.
12. Remove the (x1) 10mm bolt on the OE Up-Pipe support bracket. **See reference image 2.**
13. Remove the OE hanger rod from the isolation mount.
14. Remove OE Up-Pipe and Muffler Assembly by slightly turning the OE Up-Pipe to avoid hitting the transmission bell housing.
15. Install the aFe POWER Up-Pipe using the OE gasket and OE (x3) 12 mm nuts.
16. Slide the hanger rod on the aFe POWER Up-Pipe onto the OE isolation mount.
17. Install the aFe POWER Muffler Assembly onto the aFe POWER Up-Pipe using the supplied 3" Band Clamp.
18. Install the aFe POWER Mid-Pipe on the aFe POWER Muffler Assembly and slide the hanger rod into the OE isolation mount.
19. Install the aFe POWER Resonator onto the aFe POWER Mid-Pipe.
20. Install the aFe POWER Y-Pipe onto the aFe POWER Resonator and insert hanger rod into the OE isolation mount.
21. Tighten band clamps slightly on the aFe POWER Mid-Pipe and Y-Pipe to prevent excessive movement.
22. Install the aFe POWER Driver Side Tail-Pipe on to the aFe POWER Y-Pipe and insert hanger rod into OE isolation mount.
23. Install the aFe POWER Passenger Side Tail-Pipe on to the aFe POWER Y-Pipe and insert hanger rod into OE isolation mount.
24. Ensure that all the components of the aFe POWER exhaust system are aligned and are at a safe clearance from all wires, hoses, brake lines, body parts, and tires.
25. Start from the front of the aFe POWER exhaust system and evenly tighten all clamps and fasteners.
26. Install center brace using the (x4) 10mm 12-Point bolts and tighten.
27. Start the vehicle and check for any leaks. If any leaks are found, determine cause and repair as necessary.
28. Remove vehicle from jacks stands.
29. It is recommended to re-tighten all clamps and hardware after 50-100 miles.