



# INSTALLATION INSTRUCTIONS

**Axle-Back Exhaust**

**MAKE:** BMW  
**MODEL:** X1 28i sDrive  
**YEAR:** 2015-2021  
**ENGINE:** L4-2.0(t)

49-36349-P  
 49-36349-B

**NOTE: Does Not Fit AWD Models**

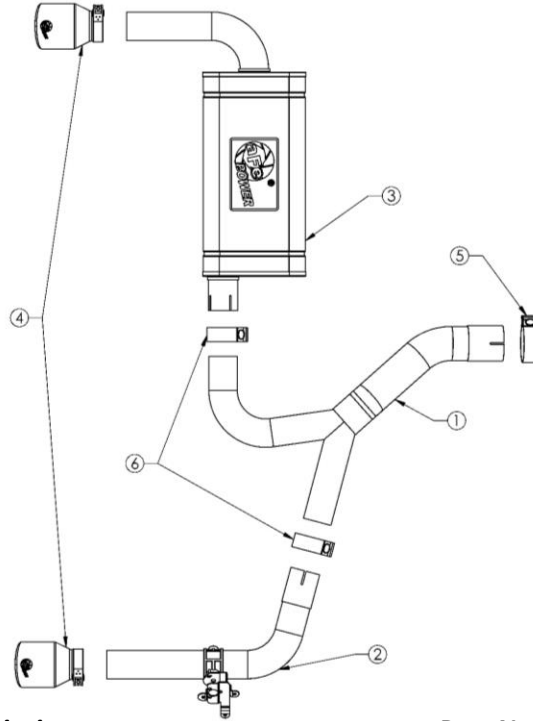

Item	Description	Part Number	Quantity
1	Y-Pipe	05-245135	1
2	Passenger Side Tailpipe	05-245136	1
3	Driver Side Tailpipe	05-245137	1
4	EXH Tip 2-1/2 In x 4 Out x 7L Bolt-On Pol	49T25404-P06	2
4	EXH Tip 2-1/2 In x 4 Out x 7L Bolt-On Blk	49T25404-B06	2
5	Clamp, Band: 3"	05-41055	1
6	Clamp, Band: 2-1/2"	05-41061	2

**aFe POWER recommends professional installation on this product.** Thoroughly inspect the aFe POWER exhaust system to make sure there is no damage from shipping (if damage is noted, immediately contact aFe POWER customer service). Allow time for your vehicle to cool down prior to installation. When working on your vehicle proceed with caution. Wear protective safety equipment; eye goggles and gloves to ensure a safe installation.

Install band clamps to proper torque specifications of 40-45 ft-lb.

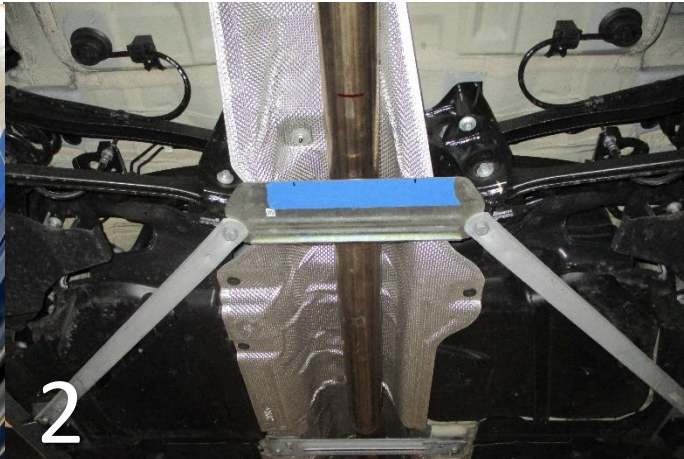



## INSTALLATION INSTRUCTIONS

**Axle-Back Exhaust**

**MAKE:** BMW  
**MODEL:** X1 28i sDrive  
**YEAR:** 2015-2021  
**ENGINE:** L4-2.0(t)

49-36349-P  
49-36349-B

**NOTE: Does Not Fit AWD Models**

1. **Read**

**instructions prior to installation.)** It is recommended to not fully tighten the exhaust until it has been fully installed. Leave loose for adjustability.

2. Secure vehicle on jack stands (refer to your manual for specified jack stand positions).
3. For faster installation, spread out the parts of the exhaust alongside your vehicle as shown in the diagram above.
4. Secure the stock exhaust with jack/stands.
5. Locate the O.E. exhaust valves in the rear section of the car and disconnect the electrical connector from the motor.
6. Cut O.E. Exhaust 4.2" from edge of plate. (See Picture 2)
7. Remove hangers from the O.E. rubber mount isolators.
8. Carefully remove muffler section of the O.E exhaust.
9. With the exhaust on the ground remove the (x3) nuts holding the motor to the O.E Exhaust on the passenger side tail pipe.
10. Install the motor onto the aFe Power Passenger Side Tailpipe, ensuring that the motor is oriented correctly on the bracket. (Note: The spring on the motor should line up with the spring slots)
11. Secure the motor to the bracket with the provided hardware.
12. Install the aFe Power Y-pipe by sliding it over the cut section of the O.E. exhaust and secure it with the provided 3" band clamp.
13. Slide the aFe Power Passenger Side Tailpipe into the y-pipe and secure with 2.5" band clamp. Slide hanger into O.E. rubber isolation mount.
14. Slide the aFe Power Driver Side Tailpipe into the y-pipe and secure with 2.5" band clamp. Slide hanger into O.E. rubber isolation mount.
15. Install aFe power exhaust tips.
16. Reconnect the electrical connector to the motor.
17. Ensure that all the components of the aFe POWER exhaust system are aligned and are at a safe clearance from all wires, hoses, brake lines, body parts, and tires.
18. Start from the front of the aFe exhaust system and evenly tighten all clamps and fasteners.
19. Start the vehicle and check for any leaks. If any leaks are found, determine cause and repair as necessary.
20. Remove vehicle from jacks stands.
21. It is recommended to re-tighten all clamps and hardware after 50-100 miles.