

# **MSD** INSTALLATION INSTRUCTIONS

## **MSD Distributor Reluctor with Advance for EFI PN 8627**

### **Parts Included:**

- 1 - Reluctor
- 1 - Roll Pin
- 1 - Snap Ring

**Note:** The installation of this Reluctor requires a press. Care must be taken when disassembling the distributor and upon the assembly.

**Note:** Will not fit Fords, the reluctors are welded.

The EFI Reluctor is designed to provide an advanced ignition trigger signal to an ECU. This enables the ECU to control the ignition timing, and positions the rotor so its tip is leading into the distributor cap terminal.

There are three positions that the reluctor can be installed in. Standard, or 10° advanced for clockwise or counterclockwise rotation engines. Figure 1 shows the roll pin locations.

1. Disassemble the distributor by removing the gear and the shaft and pull the shaft from the housing.
2. Slide the reluctor/advance assembly off the shaft.
3. Remove the snap ring from below the reluctor (Figure 2).
4. Using a piece of round stock or a punch (.625"), carefully press the advance assembly from the reluctor.
5. Position the new reluctor in the desired advanced location. Support the advance assembly in the center to prevent damaging the weight pins. Carefully press the new reluctor onto the advance assembly. Be sure to keep the pin slot aligned!
6. Press, or gently tap the new dowel pin into the pin slot.
7. Install the snap ring making sure it snaps into the groove on the housing.
8. Reinstall the assembly to the shaft and assemble the distributor.

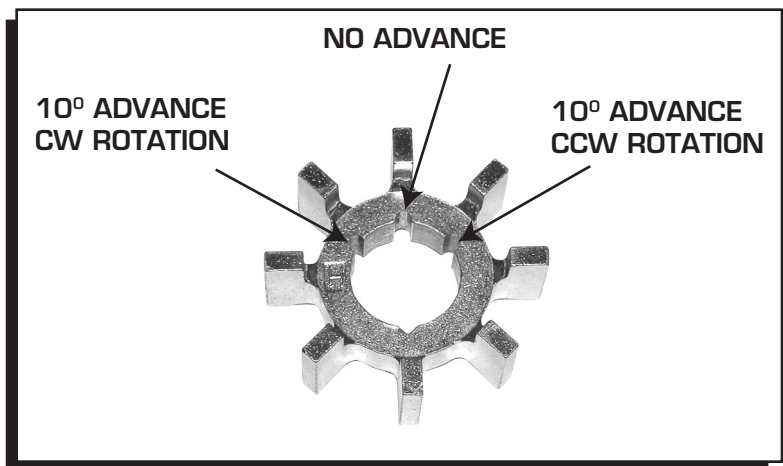

**Figure 1 Reluctor Assembly Locations.**

A PRESS MUST BE USED WHEN INSTALLING THE RELUCTOR. USING A HAMMER COULD RESULT IN DAMAGE TO THE RELUCTOR OR SHAFT BUSHING.

NOTE: WILL NOT FIT FORDS, THE RELUCTORS ARE WELDED.

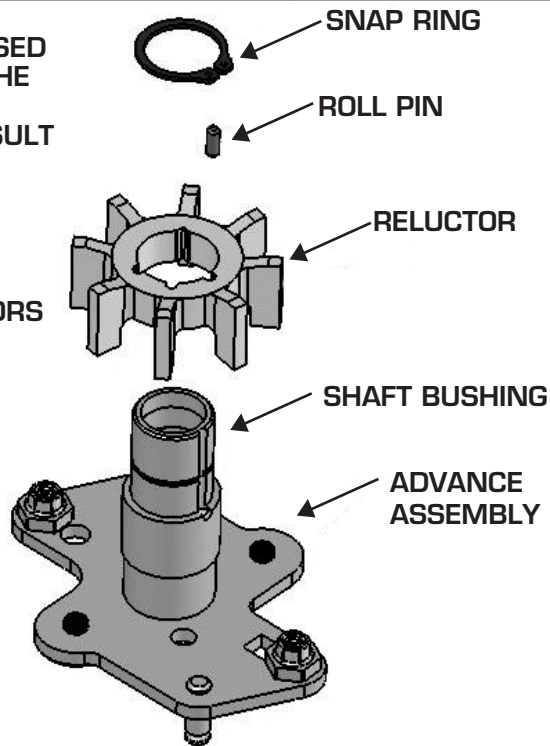

Figure 2 Reluctor Assembly.

### Service

In case of malfunction, this MSD component will be repaired free of charge according to the terms of the warranty. When returning MSD components for warranty service, **Proof of Purchase** must be supplied for verification. After the warranty period has expired, repair service is based on a minimum and maximum fee.

**All returns must have a Return Material Authorization (RMA) number** issued to them before being returned. To obtain an RMA number please contact MSD Customer Service at 1 (888) MSD-7859 or visit our website at [www.msdpower.com/rma](http://www.msdpower.com/rma) to automatically obtain a number and shipping information.

When returning the unit for repair, leave all wires at the length in which you have them installed. Be sure to include a detailed account of any problems experienced, and what components and accessories are installed on the vehicle. The repaired unit will be returned as soon as possible using Ground shipping methods (ground shipping is covered by warranty). For more information, call MSD at (915) 855-7123. MSD technicians are available from 7:00 a.m. to 5:00 p.m. Monday - Friday (mountain time).

### Limited Warranty

MSD warrants this product to be free from defects in material and workmanship under its intended normal use\*, when properly installed and purchased from an authorized MSD dealer, for a period of one year from the date of the original purchase. This warranty is void for any products purchased through auction websites. If found to be defective as mentioned above, it will be repaired or replaced at the option of MSD. Any item that is covered under this warranty will be returned free of charge using Ground shipping methods.

This shall constitute the sole remedy of the purchaser and the sole liability of MSD. To the extent permitted by law, the foregoing is exclusive and in lieu of all other warranties or representation whether expressed or implied, including any implied warranty of merchantability or fitness. In no event shall MSD or its suppliers be liable for special or consequential damages.

\*Intended normal use means that this item is being used as was originally intended and for the original application as sold by MSD. Any modifications to this item or if it is used on an application other than what MSD markets the product, the warranty will be void. It is the sole responsibility of the customer to determine that this item will work for the application they are intending. MSD will accept no liability for custom applications.