

Installation instructions

For set # 11.3110
06-UP Mazda MX-5 Miata
Rear Control Arm Bushing Set



1131 VIA CALLEJON, SAN CLEMENTE, CA 92673

© 2014 Energy Suspension. All rights reserved.
May not be reproduced, in any form, or by any means,
without the written consent of Energy Suspension.

It is recommended that if you are unfamiliar with this type of work that you refer to a qualified service center specializing in this type of work. It is also recommended that if you choose to do this work yourself that a factory service manual be obtained for the proper procedures pertaining to removal, replacement and proper torque specifications for your vehicle. This instruction set is intended as a guideline for the safe installation of Energy Suspension's polyurethane bushings, once you have removed the factory components from your vehicle. Wheel alignment is almost always disturbed when suspension components are removed or replaced. It is recommended that you have the alignment checked on your vehicle at a qualified alignment shop. Energy Suspension recommends that you read over all the installation instructions and check all P/N's and quantities in the parts list before you start. Call customer service at 949-361-3935 if the parts in your kit do not match this parts list. Prior to installation, make sure that your vehicle is in excellent mechanical condition and that there are no suspension or steering related problems. This part has been designed to work only with a vehicle that is in good state of repair. No matter how carefully we design our parts, this is one area we have no control over and cannot be held responsible.

Parts list: 11.3110

4 - 07P07147

Rear Trailing Link Upper

2 - 15.10.583.39

.750" x .480" x 1.865" Sleeve

8 - 07P07150

Rear Knuckle & Trailing Link Lower

4 - 15.10.497.39

.875" x .500" x 1.880" Sleeve

4 - 07P07151

Rear Lateral Link Upper

2 - 15.10.584.39

.750" x .480" x 2.160" Sleeve

4 - 07P07148

Rear Lateral Link Lower

2 - 15.10.519.39

1.00" x .625" x 2.350" Sleeve

4 - 07P07149

Rear Toe Control Link

2 - 15.10.53.39

.875" x .625" x 1.675" Sleeve

4 - 15.03.99.39

1.295" x .500" x .225" Cap Washer

1 - 17P17638

Instruction Sheet

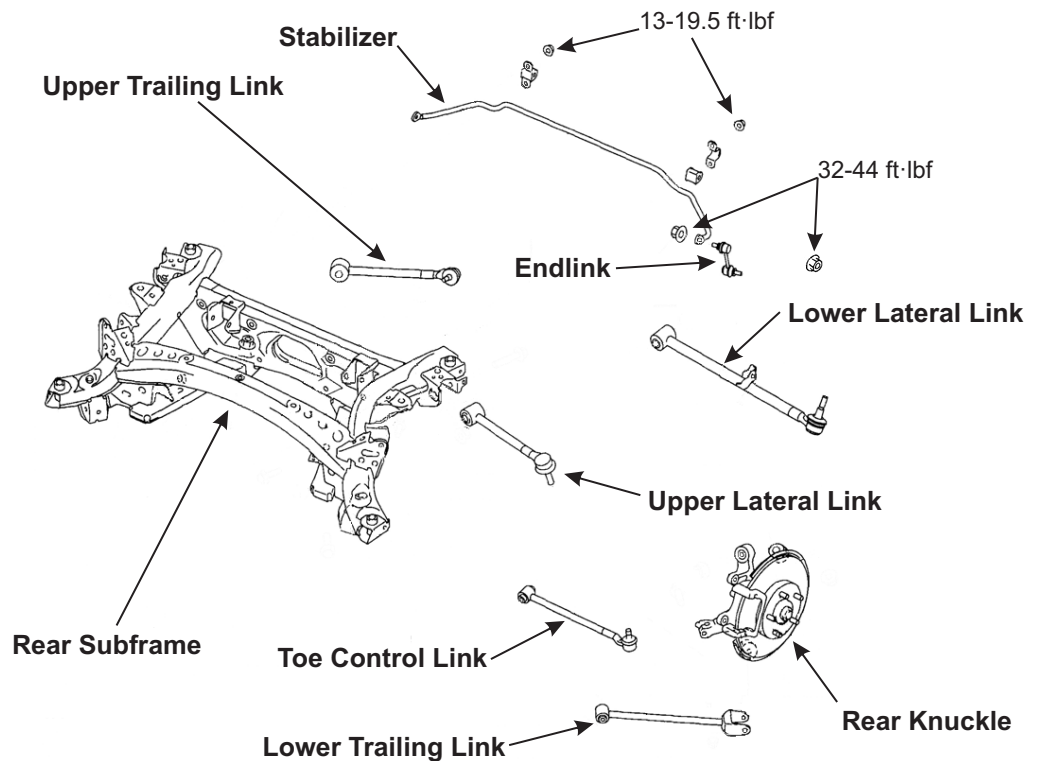

BUSHING REMOVAL/INSTALLATION

ATTENTION: We recommend acquiring a Mazda factory workshop manual for all warnings and procedures to safely remove and install the upper and lower trailing, lateral and toe control links.

REMOVAL: Properly lift and support the vehicle with jack stands. Remove both rear wheels. Place matchmark on the front and rear adjusting cams before you start. You will need to use these matchmark to reinstall the toe control links back in the same position after the new polyurethane bushings are installed. Only remove one link at a time, this will keep the rear knuckle supported and easy to reinstall the links. To remove the rubber bushing and sleeve out of the eye. Use a propane or MAPP gas torch and, with a fairly hot flame, slowly heat the exposed circumference of the eye. USE EXTREME CAUTION WHEN HEATING AND REMOVING THE OLD RUBBER AND SLEEVE AS THEY ARE UNDER PRE-LOAD AND CAN "SHOOT" OUT OF THE EYE. Make sure to keep the flame moving and not to hold it in one spot for too long. It is usually best to work the flame around the outside of the bushing in a circle. When sizzling/smoke is seen, the bond between the bushing and sleeve is broken and the bushing can be carefully pushed out with pliers or a screwdriver. Once bushing/sleeve is out, clean out all scraps of rubber and use emery paper to remove the sharp edges from ID of eye as preparation for new polyurethane bushing. To remove the old rubber bushing from the lower position on the knuckle use a piece of all-thread, tubing, flat washers and nuts. The tubing needs to be big enough for the old bushing to fall into. Tighten the nuts until the old bushing falls out.

INSTALLATION: Grease all sides of the bushing that contact metal. Grease the I.D. of the eyes and the O.D. of the new sleeves. Use an arbor press to install the new polyurethane bushings. Reinstall the links into the vehicle and torque all nuts and bolts to factory specs. It is recommended that you have the alignment checked on your vehicle at a qualified alignment shop after replacing the bushings.

Installation instructions

For set # 11.3110
06-UP Mazda MX-5 Miata
Rear Control Arm Bushing Set

1131 VIA CALLEJON, SAN CLEMENTE, CA 92673

© 2014 Energy Suspension. All rights reserved.
May not be reproduced, in any form, or by any means,
without the written consent of Energy Suspension.

